

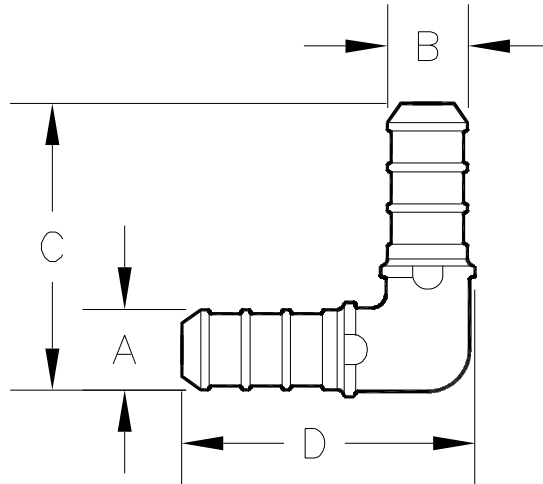

QuickSert CR™ Barb x Barb Elbow QQPE__X Specification Sheet

Tag _____

Dimensional Data: Inches and [mm] are subject to manufacturing tolerances and change without notice.



Part Number	Description	'A' in [mm]	'B' in [mm]	'C' in [mm]	'D' in [mm]
QQPE33X	1/2" Barb x 1/2" Barb Elbow	0.473" [12.0]	0.473" [12.0]	1.13" [28.7]	1.13" [28.7]
QQPE43X	3/4" Barb x 1/2" Barb Elbow	0.668" [17.0]	0.473" [12.0]	1.20" [30.5]	1.20" [30.5]
QQPE44X	3/4" Barb x 3/4" Barb Elbow	0.668" [17.0]	0.668" [17.0]	1.20" [30.5]	1.20" [30.5]
QQPE55X	1" Barb x 1" Barb Elbow	0.856" [21.7]	0.856" [21.7]	2.00" [50.8]	2.00" [50.8]

Engineering Specification: ZurnPEX™ QuickSert CR™ Barb x Barb elbow. The QQPE__X elbow is used to make sharp 90° bends. Molded from Acudel®. These fittings, as a system with Zurn PEX tube, are pressure rated at 160 PSI at 73°F, 100 PSI at 180°F, and 80 PSI at 200°F. These fittings are listed by NSF as complying with the following standards: NSF/ANSI Standard 14, NSF/ANSI Standard 61, ASTM F877, and CSA B137.5, and ASTM F2159.

Accessories

- ___ **QCLP3X** 1/2" QuickClamp Crimp Ring
- ___ **QCLP4X** 3/4" QuickClamp Crimp Ring
- ___ **QCLP5X** 1" QuickClamp Crimp Ring
- ___ **QCR3X** 1/2" Copper Crimp Ring
- ___ **QCR4X** 3/4" Copper Crimp Ring
- ___ **QCR5X** 1" Copper Crimp Ring

Rev. A	Date: 06/26/08	C.N. No. 98689
Dwg. No. 82186		Prod. No. QQPE__X