

# COMMUNICATIONS CONNECTIVITY

## Ortronics® Connectivity

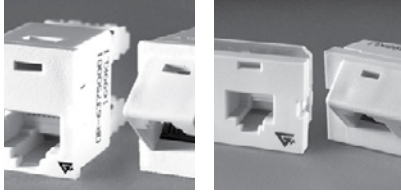

### TracJack Individual Jack System

- Front-loading, snap-in design supports future moves adds and changes
- Inserts for voice, data, audio, and video
- Available Category 3, 5e, 6, USOC 6-position, and other media
- Flat or angled 45° exit configurations
- Choice of 13 colors and color matched to Wiremold systems
- Universal T568A/B wiring format

### Series II Front-Loading, Module System

- Module design features easy snap-in front-loading design
- Linear 110 punch down format for easy termination
- Inserts for voice, data, audio, and video
- Available Category 3, 5e, 6, USOC 6-position, and other media
- Available in flat or angled 45° exit configurations
- Color matched to Wiremold Systems

For detailed product selection refer to the Ortronics Catalog or visit [www.ortronics.com](http://www.ortronics.com).

## Wiremold® Open Connectivity Solutions

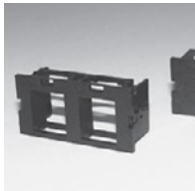

### Wiremold Open System Communications Modules

- Accommodate a wide range of manufacturers' communications outlets including keystone jacks, as well as proprietary solutions from Systimax (Avaya) and NORDX
- Modules fit into a wide range of Wiremold Systems
- Pre-punched faceplates accept common communication devices

For more information on integrating connectivity into Wiremold Cable Management Systems, contact the Wiremold Applications Engineering Team or your local Wiremold Sales Representative.

## Typical Installation for Cable Management Applications

CM-EPLA

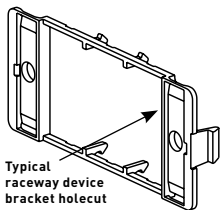

Typical  
raceway device  
bracket holecut

1. Bring all station cables through the opening in the device mounting bracket.
2. Mount communication devices in unloaded inserts and terminate or attach cable per manufacturers instructions.
3. Reverse the module and snap into the device bracket. Entire faceplate must be filled with inserts or blanks.

## Typical Mounting Brackets (4050, 5450, 5550, 40N2, 2344SD-2A, 2444D-2A and WSA07A Device Mounting Plates)

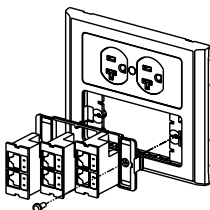

1. Insert CM-EPLA end plate into the bracket opening.
2. Slide end plate to engage hooks into locking slots. (Be sure end plate edge is seated against edge of trim plate opening.) Two end plates are required as shown.
3. After end plates are in place, install modules by aligning over space between end plates and pushing inward until snaps engage. 6A configuring options apply to opening.

## CM SERIES™ COMMUNICATION MODULES



Wiremold® CM Series™ Communication Modules provide a variety of unloaded modules to accept devices from other manufacturers. These open system modules provide a flexible and aesthetically pleasing way to connect communication cabling at the point-of-use.

## CODE REFERENCE

**cULus Listed Communication Circuit Accessories:**

File E145222 Guide DUXR.

Meets Article 800 of NEC.

Meets Article 60-308 of CEC.

## CM Series Communication Modules Ordering Information

## 2A Single Flushmount Unloaded Keystone Module

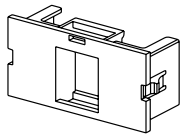

## PART NUMBERS:

**CM2-U1KEYA-WH** (White)  
**CM2-U1KEYA-GY** (Light Gray)  
**CM2-U1KEYA-BK** (Black)  
**CM2-U1KEYA-G** (Gray)

Accepts keystone jacks with a latching area of 0.58" x 0.76" [14.7mm x 19.3 mm].

## 2A Single Systimax (Avaya) Unloaded Module

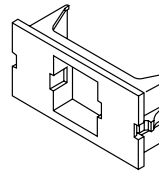

## PART NUMBERS:

**CM2-U1ATT-WH** (White)  
**CM2-U1ATT-GY** (Light Gray)  
**CM2-U1ATT-BK** (Black)  
**CM2-U1ATT-G** (Gray)

Accepts both M-series jacks and LC fiber adapters.

## 2A Dual Flushmount Unloaded Keystone Module

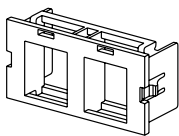

## PART NUMBERS:

**CM2-U2KEYA-WH** (White)  
**CM2-U2KEYA-GY** (Light Gray)  
**CM2-U2KEYA-BK** (Black)  
**CM2-U2KEYA-G** (Gray)

Accepts keystone jacks with a latching area of 0.58" x 0.76" [14.7mm x 19.3 mm].

## 2A Single Systimax (Avaya) Unloaded Module

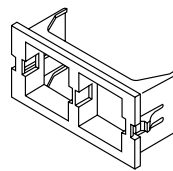

## PART NUMBERS:

**CM2-U2ATT-WH** (White)  
**CM2-U2ATT-GY** (Light Gray)  
**CM2-U2ATT-BK** (Black)  
**CM2-U2ATT-G** (Gray)

Accepts both M-series jacks and LC fiber adapters.

## COLOR OPTIONS



CM Series™ Communication Modules standard color is ivory. For other colors, add one of the following suffixes: "-WH" for white, "-GY" for light gray (matches aluminum and nonmetallic products), "-BK" for black, or "-G" for gray (matches Wiremold gray steel products).

## CM SERIES™ COMMUNICATION MODULES

## Ordering Information

## CM Series Communication Modules Specialty Mounting Adapters Ordering Information

## End Plate

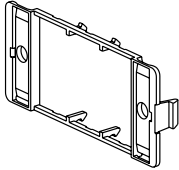

**PART NUMBERS:**  
**CM-EPLA-WH** (White)  
**CM-EPLA-FW** (Fog White)  
**CM-EPLA-G** (Gray)

End plates with two outlet ID labels with clear covers and two matching screw covers. Required when mounting modules into 4050, 5450, 5550, and WSA07-4A device mounting brackets, and the V2444D-2A and 2344SD-2A 2-gang divided raceway box.

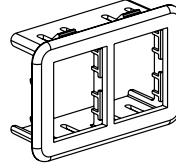
**AB2TJ**  
**Ortronics® TracJack 2A Mini Mounting Adapter**

**PART NUMBERS:**  
**AB2TJ-WH** (White)  
**AB2TJ-GY** (Light Gray)  
**AB2TJ-BK** (Black)  
**AB2TJ-G** (Gray)

Accepts two Ortronics® TracJack Inserts.

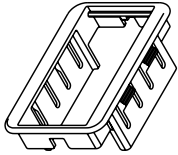
**CM2/Activate 2A Mini Mounting Adapter**

**PART NUMBERS:**  
**CM-2AB-WH** (White)  
**CM-2AB-GY** (Light Gray)  
**CM-2AB-BK** (Black)  
**CM-2AB-G** (Gray)

Accepts one CM2 Series communication module or one Pass & Seymour 2A Activate Series insert.

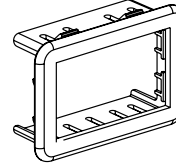
**Ortronics® Series II 2A Mini Mounting Adapter**

**PART NUMBERS:**  
**ABS2-WH** (White)  
**ABS2-GY** (Light Gray)  
**ABS2-BK** (Black)  
**ABS2-G** (Gray)

Accepts one Ortronics® Series II 1-unit insert.

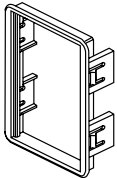
**6A Mini Mounting Adapter**

**PART NUMBERS:**  
**CM-MAB-GY** (Light Gray)  
**CM-MAB-BK** (Black)  
**CM-MAB-FW** (Fog White)

6A opening. Must be purchased separately for mounting communication modules in service fittings where it is indicated they are not included.

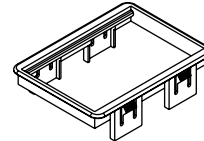
**Ortronics Series II 6A Mounting Adapter**

**PART NUMBERS:**  
**MAB3S2-GY** (Light Gray)  
**MAB3S2-BK** (Black)  
**MAB3S2-G** (Gray)

Accepts three Ortronics® Series II 1-unit inserts.

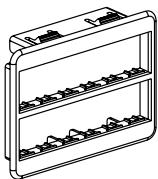
**Ortronics® TracJack 6A Mounting Adapter**

**PART NUMBERS:**  
**MAB6TJ-GY** (Light Gray)  
**MAB6TJ-BK** (Black)  
**MAB6TJ-G** (Gray)

Accepts six Ortronics® TracJack inserts.

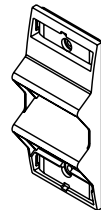
**Angled Raceway Adapter**

**PART NUMBERS:**  
**CM-ARA-WH** (White)  
**CM-ARA-GY** (Light Gray)  
**CM-ARA-G** (Gray)

For use with multi-channel raceway device brackets and WallSource device mounting brackets. Angled exit provides additional mounting depth required for audio/visual connections as well as ensuring the required bend radius for UTP and fiber optic cabling. Holds two CM2 Series modules or two 2A inserts. Fits 5507 Series Faceplate opening.

# 2400D<sup>®</sup> SERIES RACEWAY



Dual channel version of 2400 Series Raceway. Easy-to-install and ideal for basic power and communication/low voltage installations in classrooms, hotels, and anywhere a low profile raceway solution is needed.

## CODE REFERENCE

**cULus Listed Raceway:**  
File E4376 Guide RJBT.

**Fittings:**  
File E41751 Guide RJPR.  
Meets Article 386 of NEC.  
Meets Section 12-1600 of CEC.

## 2400D Series Raceway System Layout for Power & Data

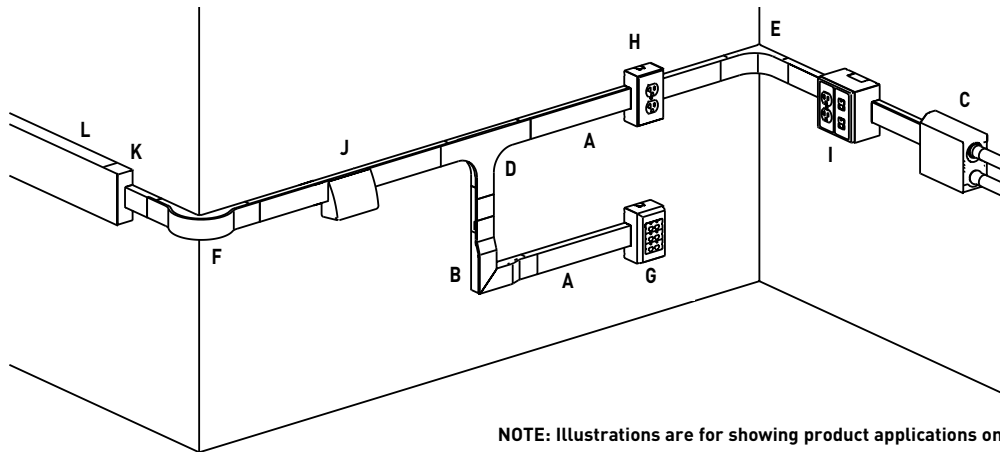

**NOTE:** Illustrations are for showing product applications only.

### KEY

- |  |  |
|--|--|
| A. 2400D 2400 Series Divided Raceway       | H. 2444D One-Gang Device Box             |
| B. 2411DFO Radiused Divided Flat Elbow     | I. 2444D-2A Two-Gang Divided Device Box  |
| C. 2410DFO Divided Entrance End Fitting    | J. 24DWND Downward Duplex Device Bracket |
| D. 2415DFO Radiused Divided Tee            | 24DWNR Downward Decorator Device Bracket |
| E. 2417DFO Radiused Divided Internal Elbow | K. 4089 Reducing Connector               |
| F. 2418DFO Divided External Elbow          | L. U4000 Series Raceway                  |
| G. 2444 One-Gang Extra Deep Device Box     |  |

### COLOR OPTIONS

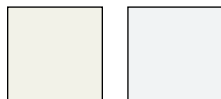

2400 Series™ Raceway Part Numbers with a "V" prefix have an ivory finish. Part Numbers with a "-FW" suffix have a fog white finish.

**Custom color options are also available. Consult the factory for more information.**

# 2400D SERIES™ RACEWAY

## 5507 Series Faceplates Ordering Information (continued)

### Single Receptacle Faceplate

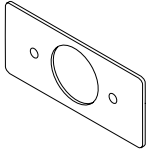

**PART NUMBERS:**  
**5507T2** (Ivory)  
**5507T2-FW** (Fog White)

Covers single receptacles 1.41" [35.8mm] diameter.

### Extron® AAP Faceplate

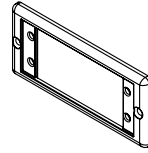

**PART NUMBERS:**  
**5507AAP** (Ivory)  
**5507AAP-FW** (Fog White)  
**5507AAP-WH** (White)  
**5507AAP-G** (Gray)  
**5507AAP-BK** (Black)

Metal faceplate for use with two Extron® Electronics AAP single space modules.

### Dual RJ11/RJ45 Connector Faceplate

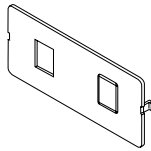

**PART NUMBERS:**  
**5507RJ** (Ivory)  
**5507RJ-FW** (Fog White)

Accepts one or two keystone device modules. Has one keystone opening and a KO for the other.

### 5507MAAP Extron® MAAP Faceplate

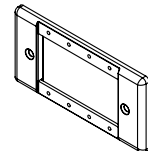

**PART NUMBERS:**  
**5507MAAP** (Ivory)  
**5507MAAP-FW** (Fog White)  
**5507MAAP-WH** (White)  
**5507MAAP-G** (Gray),  
**5507MAAP-BK** (Black)

Metal faceplate for use with four Extron® Electronics MAAP single space modules.

### Flush Dual RJ11/RJ45 Connector Faceplate

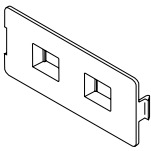

**PART NUMBERS:**  
**5507FRJ** (Ivory)  
**5507FRJ-FW** (Fog White)

Accepts one or two keystone device modules, recessed to provide a flush installation. Has one keystone opening and a KO for the other.

### End Plates

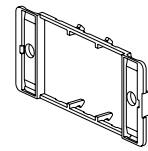

**PART NUMBERS:**  
**CM-EPLA** (Ivory)  
**CM-EPLA-FW** (Fog White)

Mounts Pass & Seymour® Activate and Wiremold Open System communication modules into 5507 opening. Includes two outlet identification labels with clear covers and two matching screw covers.

### Ortronics® Faceplate

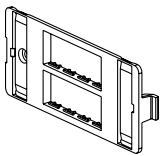

**PART NUMBERS:**  
**5507-4TJ** (Ivory)  
**5507-4TJFW** (Fog White)

Accepts four Ortronics® TracJack Devices.

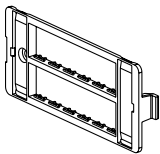

**PART NUMBERS:**  
**5507-6TJ** (Ivory)  
**5507-6TJFW** (Fog White)

Accepts six Ortronics® TracJack Devices.

### End Plates

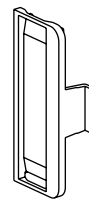

**PART NUMBERS:**  
**S2-EPL** (Ivory)  
**S2-EPL-FW** (Fog White)

Mounts Ortronics® Series II modules into 5507 opening. Includes two outlet identification labels with clear covers and two matching screw covers.