

**For Commercial & Residential Applications**

Job Name \_\_\_\_\_  
 Job Location \_\_\_\_\_  
 Engineer \_\_\_\_\_  
 Approval \_\_\_\_\_

Contractor \_\_\_\_\_  
 Approval \_\_\_\_\_  
 Contractor's P.O. No. \_\_\_\_\_  
 Representative \_\_\_\_\_

# Metal Tailpieces



**Single Flanged**

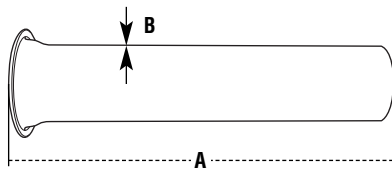

**Double Flanged**

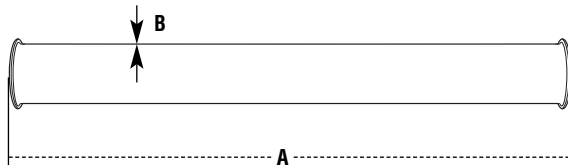

MODEL	✓ TO SUBMIT	DESCRIPTION	DIMENSIONS		FINISH
			A in. mm.	B	
<b>Single Flanged</b>					
700 223		1 1/4" x 4"	4	102	22 GA. Chrome
701 223		1 1/4" x 6"	6	152	22 GA. Chrome
702 223		1 1/4" x 8"	8	203	22 GA. Chrome
704 223		1 1/4" x 12"	12	305	22 GA. Chrome
705 221		1 1/2" x 4"	4	102	22 GA. Rough Brass
705 223		1 1/2" x 4"	4	102	22 GA. Chrome
706 221		1 1/2" x 6"	6	152	22 GA. Rough Brass
706 223		1 1/2" x 6"	6	152	22 GA. Chrome
707 221		1 1/2" x 8"	8	203	22 GA. Rough Brass
707 223		1 1/2" x 8"	8	203	22 GA. Chrome
709 221		1 1/2" x 12"	12	305	22 GA. Rough Brass
709 223		1 1/2" x 12"	12	305	22 GA. Chrome
718 221		1 1/2" x 18"	18	457	22 GA. Rough Brass
719 221		1 1/2" x 24"	24	610	22 GA. Rough Brass
705 201		1 1/2" x 4"	4	102	20 GA. Rough Brass
705 203		1 1/2" x 4"	4	102	20 GA. Chrome
706 201		1 1/2" x 6"	6	152	20 GA. Rough Brass
706 203		1 1/2" x 6"	6	152	20 GA. Chrome
707 201		1 1/2" x 8"	8	203	20 GA. Rough Brass
707 203		1 1/2" x 8"	8	203	20 GA. Chrome
709 201		1 1/2" x 12"	12	305	20 GA. Rough Brass
709 203		1 1/2" x 12"	12	305	20 GA. Chrome
706 171		1 1/2" x 6"	6	152	17 GA. Rough Brass
706 173		1 1/2" x 6"	6	152	17 GA. Chrome
707 171		1 1/2" x 8"	8	203	17 GA. Rough Brass
707 173		1 1/2" x 8"	8	203	17 GA. Chrome
709 171		1 1/2" x 12"	12	305	17 GA. Rough Brass
709 173		1 1/2" x 12"	12	305	17 GA. Chrome
<b>Double Flanged</b>					
754 222		1 1/2" x 16"	16	406	22 GA. Chrome
755 222		1 1/2" x 12"	12	305	22 GA. Chrome
754 202		1 1/4" x 16"	16	406	20 GA. Chrome



815 Chestnut Street • N. Andover, MA 01845  
 Tell: 978.688.1811 Fax: 978.794.1848  
 www.wattsbrass-tubular.com

Watts product specifications in U.S. customary units and metric are approximate and are provided for reference only. For precise measurements, please contact Watts Technical Service. Watts reserves the right to change or modify product design, construction, specifications, or materials without prior notice and without incurring any obligation to make such changes and modifications on Watts products previously or subsequently sold.