

Submittal Package

viiega

Viega® PEX Crimp PolyAlloy™ Fittings

Technical Data

Materials:

Fittings.....	PolyAlloy
Crimp Rings.....	Copper (black)
MANABLOC Manifolds.....	Polysulfone (plastic) PolyAlloy fittings
PEX Crimp Poly Manifolds.....	PolyAlloy crimp connections
Valves.....	PolyAlloy
ViegaPEX, ViegaPEX Ultra Tubing.....	PEX (crosslinked polyethylene)

Applications

Viega PEX Crimp zero lead brass and Polyalloy PEX Crimp fittings are intended for use in potable water systems. They can be directly buried in soil but shall be wrapped (fittings used in concrete shall also be wrapped). Fittings are manufactured with Viega PEX Crimp barbs for use with ViegaPEX, ViegaPEX Ultra tubing, crimp rings and tools.

Installation

- Use only ASTM F1807 crimp rings and approved full circle crimp tools to make connections.
- Keep flame and excessive heat away from tubing and connections.
- Refer to the Viega PEX Installation Manual for additional information.

“Zero Lead” identifies Viega® products meeting the lead free requirements of NSF 61-G through testing under NSF/ANSI 372 (0.25% or less maximum weighted average lead content).

Codes Approvals & Standards

ANSI/NSF 61-G

cNSF® us pw-G

CSA B137.5

U.P. Code

UPC®

ASTM F876 / F877

ASTM F1807 / F2159

ICC ES-PMG™ 1038

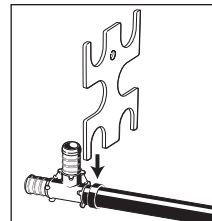
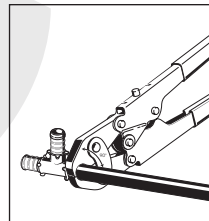
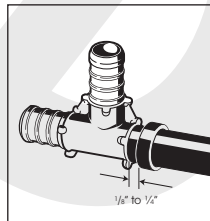

THREE SIMPLE STEPS TO A SECURE VIEGA PEX CRIMP FITTING CONNECTION.

1. SLIDE CRIMP RING OVER END OF SQUARED OFF TUBING, FULLY INSERT FITTING INTO TUBING AND POSITION THE RING 1/8" TO 1/4" FROM THE END OF TUBING.
2. KEEP THE TOOL AT 90° AND CLOSE THE HANDLES COMPLETELY. DO NOT CRIMP TWICE.
3. CHECK CRIMP WITH GO/ NO GO GAUGE.

Submittal Package

viega



Viega® PEX Crimp PolyAlloy™ Fittings

ViegaPEX and ViegaPEX UltraTubing

Material.....PEX crosslinked polyethylene
Temperature/Pressure Ratings...200°F at 80 psi
180°F at 100 psi
73.4°F at 160 psi
Linear Expansion Rate.....1.1"/100'/10°F

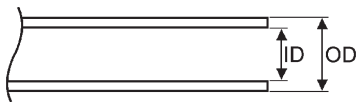

Nominal Size	Inner Diameter	Outer Diameter	Wall Thickness
3/8"	0.35	0.500±.003	0.070±.010
1/2"	0.47	0.625±.004	0.070±.010
3/4"	0.67	0.875±.004	0.097±.010
1"	0.86	1.125±.005	0.125±.013

Submittal Package

viega

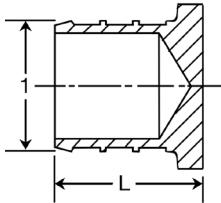

Viega PEX Crimp Test Plug Zero Lead PolyAlloy - Model V5058

Part Number	Size	L (in)
	1	
43702	3/8"	0.76
43723	1/2"	0.76
43744	3/4"	0.95
43765	1"	1.13

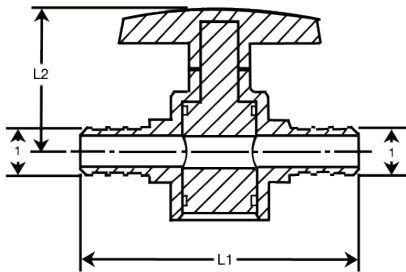

Viega PEX Crimp Valve Zero Lead PolyAlloy 1/4 Turn - Model V5236

Part Number	Size	L1 (in)	L2 (in)
	1		
43030	1/2"	2.83	1.45
43040	3/4"	3.00	1.45

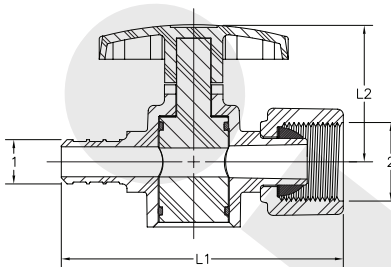

Viega PEX Crimp Stop Valve Straight Zero Lead PolyAlloy Crimp x Lav 1/4 Turn - Model V5036.30

Part Number	Size	L1 (in)	L2 (in)
	1 2		
43023	3/8" x 1/2" Lav	3.00	1.45
43031	1/2" x 1/2" Lav	3.00	1.45

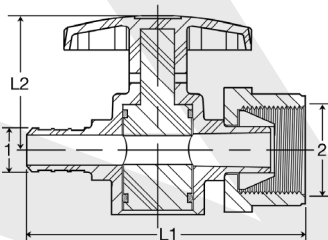

Viega PEX Crimp Stop Valve Straight Zero Lead PolyAlloy Crimp x Closet 1/4 Turn - Model V5036-31

Part Number	Size	L1 (in)	L2 (in)
	1 2		
43002	3/8" x 1/2" Closet	3.00	1.45
43003	1/2" x 1/2" Closet	3.00	1.45