

Dimensional Documentation

viega

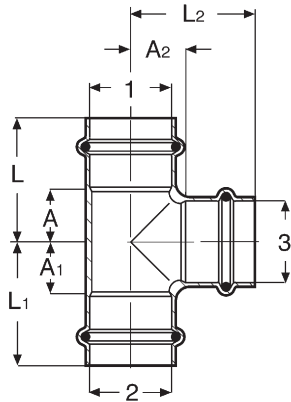

Copper Tee P x P x P - Model 2918 (continued from previous page)

Part Number	Size			A (in)	A1 (in)	A2 (in)	L (in)	L1 (in)	L2 (in)
	1	2	3						
15513	2"	1½"	¾"	0.70	1.25	1.38	2.28	2.68	2.28
15498	2"	1½"	1"	0.82	1.45	1.38	2.40	2.87	2.28
15508	2"	1½"	1¼"	0.94	1.55	1.49	2.52	2.97	2.52
15503	2"	1½"	1½"	1.13	1.65	1.37	2.72	3.07	2.80
22228	2"	1½"	2"	1.38	1.89	1.38	2.95	3.33	2.95
15538	2"	2"	1½"	0.54	0.54	1.30	2.13	2.13	2.05
94777	2"	2"	¾"	0.79	0.79	1.26	2.37	2.37	2.17
94772	2"	2"	1"	0.91	0.91	1.30	2.49	2.49	2.21
77487	2"	2"	1¼"	1.04	1.04	1.37	2.62	2.62	2.40
77482	2"	2"	1½"	1.13	1.13	1.37	2.72	2.72	2.80

Copper Cap P - Model 2956

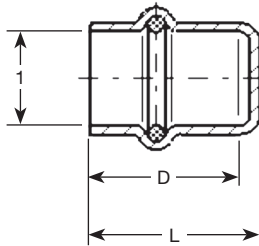

Part Number	Size		L (in)	D (in)
	1			
77712	½"		0.92	0.79
77717	¾"		1.07	0.94
77722	1"		1.11	0.99
77727	1¼"		1.32	1.20
77732	1½"		1.62	1.49
77737	2"		1.69	1.81

Copper Cross-Over P x P - Model 2928

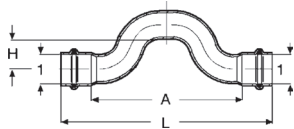

Part Number	Size		A (in)	L (in)	H (in)
	1				
77742	½"		3.62	5.12	0.77
77747	¾"		4.49	6.30	0.90

Copper Cross-Over FTG x P - Model 2927

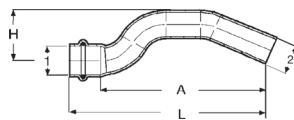

Part Number	Size		A (in)	L (in)	H (in)
	1	2			
78137	½"	½"	3.84	4.59	1.20
78142	¾"	¾"	4.64	5.54	1.54