

# UEI Accessories

TEST INSTRUMENTS™



ATPC: Pipe Clamp Adapter

## Clips & Adapters

<b>ATPC</b>	Pipe Clamp Adapter for use with K-type inputs
<b>ATPC2</b>	K-type Clamp style temperature adapter.
<b>AWL1</b>	FIREFLY Wristlight™ LED light attaches to wrist, fingers, or test leads
<b>AAC</b>	Push-on alligator clips with insulators for pointed test leads, 1 pair
<b>AAC3</b>	Screw-on alligator clips, 1 pair
<b>ACF1</b>	110V AC female adapter connector to insulated battery clips, for HA1
<b>ATHA1</b>	Gas valve thermocouple adapter
<b>ALS1</b>	Line Splitter
<b>CPA1</b>	Capacitance adapter for DMMs
<b>DLMAT2</b>	MicroAmp adapter for DMMs
<b>TA2K</b>	Dual input differential temperature adapter for DMMs
<b>ACS1</b>	Velcro pipe straps for thermocouple probes
<b>ATTEXT</b>	10' Extension for K-type thermocouples



## Test Leads

<b>ATL55</b>	UL listed insulated test leads for industry standard multimeters
<b>ATL59</b>	UL listed insulated test leads for Phoenix Clamp Meter Series™
<b>ATL60</b>	Test lead, microwave diode booster for all DMM (except DM5B)
<b>ATL85</b>	Vinyl insulated test leads for M1K
<b>ATL91</b>	Test lead set for IRT20
<b>ATL130</b>	Rubber insulated test leads, twist lock (pr.) for MCP9A
<b>ATL135</b>	Test leads for IRT3 & DMEG3
<b>ATL190</b>	Kelvin clip leads for CLM100 & CLM100B
<b>ATL250</b>	Test leads for DM5B
<b>ATL301KIT</b>	Deluxe test lead kit
<b>ATLFSG</b>	Flame safeguard relay kit, w/test lead and alligator clips

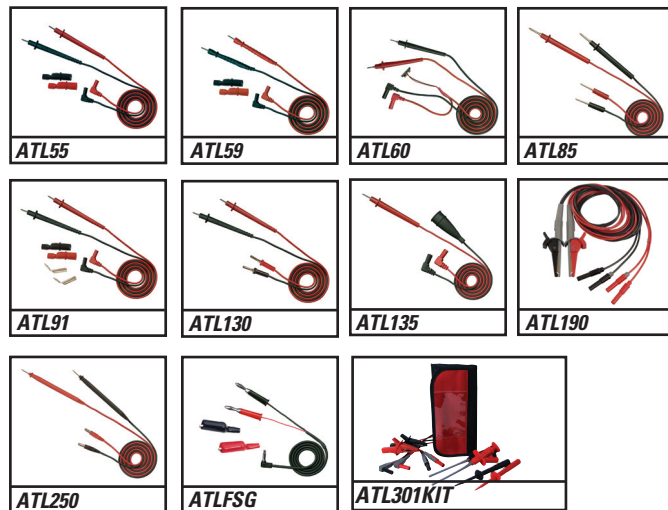

## Carrying Cases

<b>AC73</b>	Soft carrying case (15 x 12 x 3")
<b>AC75</b>	Large soft carrying case (18 x 12 x 3")
<b>AC504</b>	Hard carrying case (12.5 x 7.5 x 3.5")
<b>AC506</b>	Large hard carrying case (16 x 11 x 3.75")
<b>AC509</b>	Eagle hard carrying case (19 x 14 x 3.5")
<b>AC319</b>	Soft carrying case (5.5 x 7.5 x 2.5")
<b>AC519</b>	Soft carrying case (5.5 x 10.5 x 2.5")



# Accessories

## J-Type Temperature Probe

<b>ATT19</b>	Oven clip, flat blade 48" cord. DT301, DT302, DT304 (-40°-950°F / -40°-510°C)
<b>ATT26</b>	Liquid probe and 48" cord. DT301, DT302, DT304 (-40°-1,550°F / -40°-850°C)
<b>ATT27</b>	4' Standard bead probe. DT301, DT302, DT304 (-40°-950°F / -40°-510°C)
<b>ATT30</b>	8" Liquid probe & handle. DT301, DT302, DT304 (-40°-1,550°F / -40°-850°C)

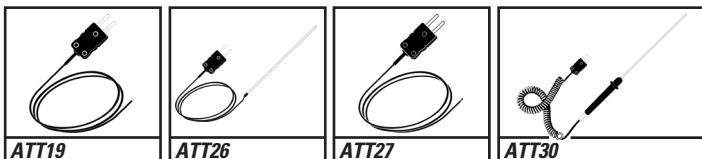

## K-Type Temperature Probe

<b>ATT29</b>	4' Standard fiber glass coated. DT301, DT302, DT304, DL389, DL379, DL369, DL259, DL250, & TA2K (-40° to 950°F / -40° to 510°C)
<b>ATT29A</b>	4' Standard fluoroplastic coated FDA approved. DT301, DT302, DT304, DL389, DL379, DL369, DL259, DL250, & TA2K (-40° to 950°F / -40° to 510°C)
<b>ATT29APACK</b>	10 PACK 4' Standard fluoroplastic coated FDA approved.
<b>ATT36</b>	8" Surface probe and handle. DT301, DT302, DT304, DL389, DL379, DL369, DL259, DL250, DT200, & TA2K (-40° to 950°F / -40° to 510°C)
<b>ATT39</b>	Temperature probe for the DT301, DT302, DT304 (-40° to 950°F / -40° to 510°C)
<b>ATT50</b>	8" Liquid probe & handle. DT301, DT302, DT304, DM520, DL297T, DL295, DL250, & TA2K (-40° to 1,550°F / -40° to 850°C)
<b>ATT70</b>	Temperature plug adapter. DL259, DL289, DL279, DL269, DM397, DM393, UTL33T
<b>ATT100</b>	6" Liquid probe and handle. DT301, DT302, DT304, DL389, DL379, DL369, DL259, DL250, & TA2K (-40° to 950°F / -40° to 510°C)

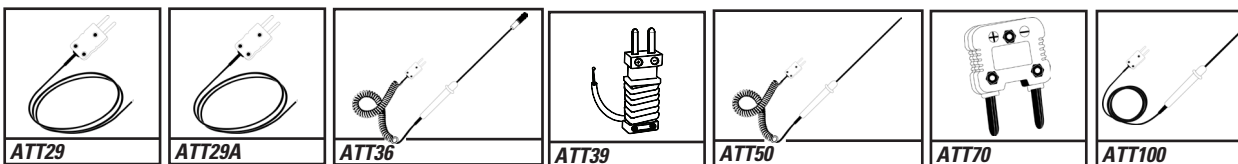

## Thermistor

<b>ATT31</b>	External temperature probe. DTH31 (-4° to 158°F / -20° to 70°C)
<b>ATT55A</b>	4" Liquid temperature probe with 30" cord. DT20A, DT15A
<b>ATT56A</b>	4" Air temperature probe with 30" cord. DT20A, DT15A
<b>ATT57A</b>	4" Surface temperature probe with 30" cord. DT20A, DT15A
<b>ATT58A</b>	Sealed probe with 15' cord. DT20A, DT15A
<b>ATT62</b>	Sealed probe with 15' cord. DT40 (-40° to 300°F / -40° to 150°C)
<b>ATT64</b>	Air probe with 15' cord. DT40 (-40° to 300°F / -40° to 150°C)

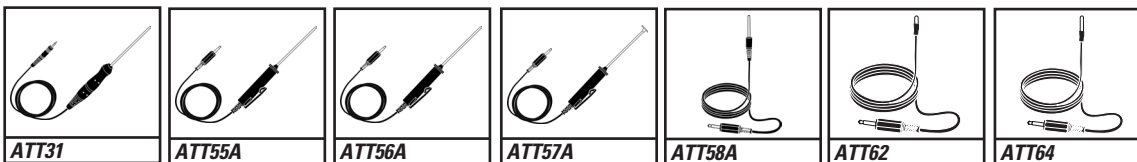

Distributed By:

**UEI**  
TEST INSTRUMENTS™

1-800-547-5740 • Fax: (503) 643-6322  
www.ueitest.com • Email: info@ueitest.com

**IN CANADA**  
Phone: 1-877-475-0648 • Fax: (604) 278-8299  
www.ueitest.com • Email: infocanada@ueitest.com

**IN EUROPE**  
Phone: +44 1707 375550 • Fax: +44 1707 393277

