

## Pedal Valves

- All models have:
- Self closing valve
  - 1/2" NPT inlet and outlet
  - Extended pedals (wall mounted models)
  - Pedals flip up and stay up for cleaning (wall mounted models)

### B-0508-02 Single Pedal Valve, Wall Mounted

- For hot or cold water
- 1" (25 mm) from wall to center of inlet
- Wall to pedal tip approximately 13-3/4" (349 mm)
- Angle loose key stop on inlet (B-1350)
- Volume control straight loose key stop (B-0416)



### B-0508-LKS Single Pedal Valve, Wall Mounted

- For hot or cold water
- 1" (25 mm) from wall to center of inlet
- Wall to pedal tip approximately 13-3/4" (349 mm)
- Straight loose key stop on inlet



## Knee Valves

- All models:
- Feed water automatically
  - Provide sensitive, variable flow control for water conservation

### B-0473 Wall Support for Knee Action Valve

- All aluminum, fastens to wall and supports valve body of knee action valve
- Approximately 12" (305 mm) from wall to valve body mounting holes
- 3-1/4" (83 mm) of knee stirrup extends in front of 20" (508 mm) back to front basin
- Can be shortened by cutting aluminum pipe
- Available in longer lengths up to 24" as a special order



### B-0473 Wall Bracket with B-0475 Knee Valve

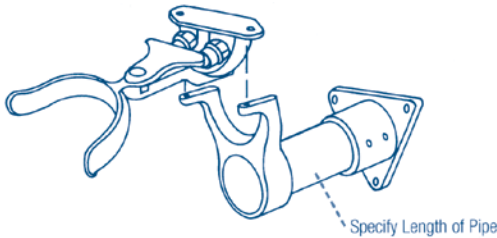

### B-0475 Knee Action Valve

- Heavy duty cam acting stirrup
- Valve will remain in set position for hot, cold or mixed water
- 1/2" NPT female inlets
- 2-1/2" (64 mm) centers
- 1/2" NPT female outlet



**B-0475-LKS** Same as B-0475 except with 1/2" NPT straight loose key stops

### B-0474 Wall Support for Knee Action Valve

- Cast aluminum
- Approximately 11-1/2" (292 mm) from wall to front
- For installation where knee action valve cannot be fastened to horizontal sink support bar
- Bracket supports inlet pipes



### B-0474 Wall Bracket with B-0475 Knee Valve

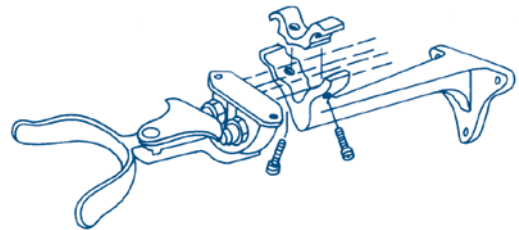

### B-0509 Double Knee Pedal Valve

- Inlets on 2-1/2" (64 mm) centers
- Approximately 24" (610 mm) from floor to base of valve
- Pedals 6-1/4" (159 mm) long

