

# Submittal Data Information 3-Speed Cartridge Circulators

Catalog # 100-51  
Submittal Data # 101-125  
Supersedes: New

Effective: 04/26/07

## Features

- 3-Speed Switch
- Fine tune to system requirements
- Highest performance & starting torque in class
- Heavy duty construction for longer life
- 4-bolt universal flange (0010 only)
- Removable high-flow Integral Flow Check (IFC®)
  - Prevents gravity flow
  - Reduces installation costs
  - Improves pump performance
- Replaceable cartridge design
- Quiet, efficient operation
- Self lubricating, no mechanical seal
- Wide range of applications
- Cast Iron, flanged construction

## Materials of Construction

Casing: Cast Iron  
Integral Flow Check (IFC®):  
Body, Plunger.....Acetal or Noryl®  
O-ring Seal.....EPDM  
Spring.....Stainless Steel  
Stator Housing: Steel  
Cartridge: Stainless Steel  
Impeller: Non-Metallic  
Shaft: Ceramic  
Bearings: Carbon  
O-Ring & Gaskets: EPDM

## Model Nomenclature

F – Cast Iron, Flanged  
MS – 3-Speed Switch  
IFC – Integral Flow Check

## Performance Data

	00R	0010
Flow Range (GPM):	0-18	0-29
Head Range (FT):	0-21	0-10.5
Minimum Fluid Temperature:	40°F (4°C)	
Maximum Fluid Temperature:	230°F (110°C)	
Maximum Working Pressure:	125 psi	
Connection Sizes:	3/4", 1", 1-1/4", 1-1/2" Flanged	



FOR INDOOR USE ONLY

Noryl is a trademark of General Electric Company

## Application

The **00R 3-Speed Radiant pump** is specifically designed for the flow and head requirements of today's radiant heat systems. Its' 3-Speed switching capability provides fine tuning control to match a wide combination of tube diameters and length of runs. The 00R 3-Speed Radiant pump is a direct replacement for the Grundfos UPS 15-58 3-Speed. The 00R delivers the highest starting torque in its class and a removable, high-flow Integral Flow Check (IFC®) that prevents gravity flow, reduces installation costs and improves pump performance.

The **0010 3-Speed Service pump** is designed as an ideal replacement circulator for service contractors to use on any emergency "no-heat" call. The 0010 3-Speed replaces most commonly used circulators. Simply install it and set the speed to match the original pump performance. The handy new four bolt flange matches up to any pump regardless of style, type or age.

## Pump Dimensions & Weights

	A		B		C		D		F		G		Ship Wt.	
	in.	mm	in.	mm	in.	mm	in.	mm	in.	mm	in.	mm	lbs.	Kg
Cast Iron Models														
00R-MSFI-IFC	6-1/2	165	4-5/8	118	3-3/16	81	3-7/16	87	5-3/8	137	6-3/8	162	9	4.0
00R-MSFI-I IFC	6	152	4-5/8	118	3-3/16	81	3-7/16	87	5-3/8	137	6-3/8	162	9	4.0
0010-MSFI-IFC	6-11/16	170	4-3/4	120	3-3/16	81	3-7/16	87	5-1/2	140	6-3/8	162	10	4.5

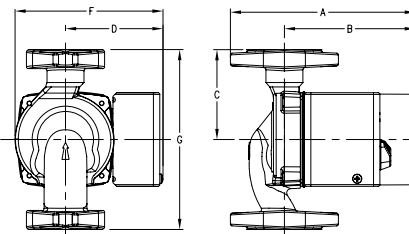

## Mounting Positions

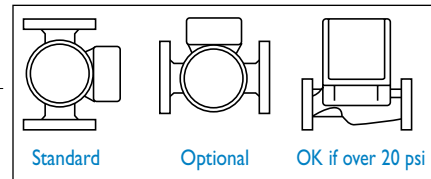

## Electrical Data

Model	Volts	Hz	Ph	Amps			RPM	HP
				Speed 1	Speed 2	Speed 3		
All Models	115	60	1	.75	.91	1.10	3250	1/20
Motor Type	Permanent Split Capacitor Thermally Protected							

## Flange Orientation

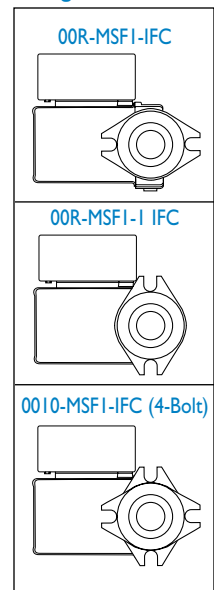

## Performance Field - 60Hz

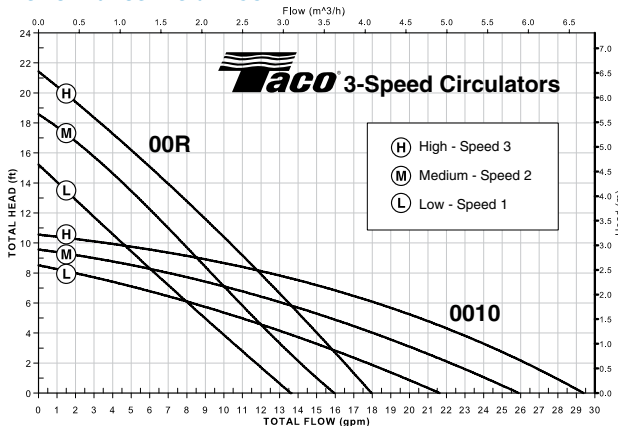



> English > Español > Py

Search Login Regis

THE LEADER IN HYDRONIC SYSTEMS AND COMPONENTS

ABOUT US PRODUCTS APPLICATIONS SUPPORT NEWS CONT

## Taco-HVAC Site Search

### Part Number

- 00R-MSF1-IFC - CIRC,3-SPD,FLGD,RADIANT,115V

### Searches by other users

- 00R-MSF1-IFC
- ANGLE VALVE
- 007
- bearing assemblies
- 007

### Have you seen our wizards?

- Pump Selection
- Document Wizard
- CAD Wizard

