

CATALOG NUMBER

ECQL1

electricCenter
ACCESSORIES

Handle Blocking Device

Same As:

- QL1
- BX031HB



Package contains 10 devices.

30783643465627

INSTALLATION INSTRUCTIONS



⚠ DANGER

Hazardous Voltage.
Will cause death,
serious injury or substantial
property damage.

Turn off power supplying this
equipment before working inside.

⚠ SAFETY INSTRUCTIONS

Note: This instruction outlines the recommended installation procedure.

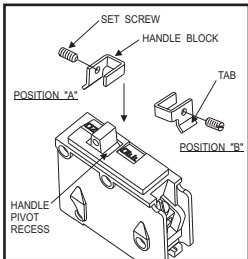

1. Turn off and lock off the power supplying the load center before working inside.
2. Orient handle block in either position "A" or position "B" (depending upon whether handle is to be blocked in "OFF" or "ON" position).
3. Slide handle block down over the handle until tab rests in handle pivot recess of breaker.
4. Tighten set screw.

© 2007 Copyright Siemens Industry, Inc.

600637A Rev.X

Siemens Industry, Inc. Norcross, Georgia U.S.A. Assembled in Mexico

PART NO. **600637A**