

Updated 60 Amp Circuit Breaker Enclosure

Features

- UL listed
- NEMA 3R for outdoor use
- 60A max rating
- 1 phase, 3 wire
- Interior with integrated neutral^①
- Uses HA type hubs^②
- Cover plate included
- Lifetime warranty on Siemens installed circuit breakers

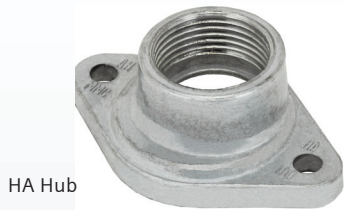
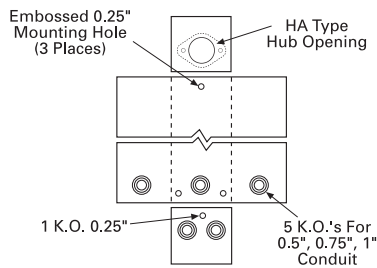

Catalog number	Brand	One inch spaces	Max circuits	Dimensions (inches)			
				Length	Width	New depth ^①	Old depth
W0204ML1060	Siemens	2	4	8.00	5.50	3.44	4.25
LW002GR	Murray	2	4	8.00	5.50	3.44	4.25

Hub options (sold separately)

Catalog number	Hub size
ECHA075	3/4"
ECHA100	1"
ECHA125	1-1/4"

^① Change from previous offering

Data Sheet

www.usa.siemens.com/residential

SIEMENS

Siemens Industry, Inc.
Building Technologies Division
5400 Triangle Parkway
Norcross, GA 30092

800-241-4453
info.us@siemens.com

www.usa.siemens.com/residential

Subject to change without prior notice
Order No.: RPFL-60CBE-0111
Printed in USA
© 2011 Siemens Industry, Inc.

The information provided in this flyer contains merely general descriptions or characteristics of performance which in case of actual use do not always apply as described or which may change as a result of further development of the products. An obligation to provide the respective characteristics shall only exist if expressly agreed in the terms of contract.

All product designations may be trademarks or product names of Siemens AG or supplier companies whose use by third parties for their own purposes could violate the rights of the owners.