

# ACHIEVE THE BEST LOOK BY CONCEALING ALL THE PLUMBING



SFA Saniflo introduced the Extension Pipe to ease the installation process and make it easier to hide the pump and plumbing behind any finished wall. This extension pipe is used with the Saniaccess3, Saniplus, Sanibest Pro and Sanitop systems.

The 18" extension pipe was designed with the idea to reduce time when installing the macerating and grinding systems. It has an inner gasket which connects to the rear spigot of the Saniflo toilet without any difficulty. Its sealed connection keeps water from seeping out once the toilet is flushed.

The ease of installation is the reason why installers recommend the extension pipe for any Saniflo installation. When using the extension pipe, the toilet bowl should be raised 3/8 inch for additional gravity flow toward the macerating or grinding system.

## DIMENSIONS:

|                                       |     |
|---------------------------------------|-----|
| Length:                               | 18" |
| Diameter of pipe (smaller end):       | 4"  |
| Diameter of bell housing (Large end): | 5"  |

Part # 030

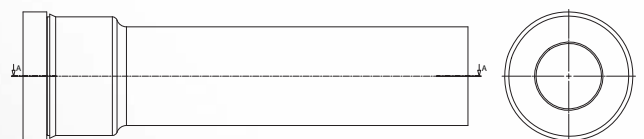

**If you have installation questions about our products or possible applications, please contact our technical department at our toll free number US: 800-571-8191, Canada: 800-363-5874**