

Electronic Gas Control Replacement Instructions

For The Bradford White TTW1 & 2 (-1 series) Models

To be performed only by Qualified Service Providers

Gas Control Removal From Thermal Well

Follow the steps below allows removal of gas control from thermal well without removing thermal well from tank.

- Step 1. Position gas control power switch to the "OFF" position and unplug water heater from power supply.
- Step 2. Turn off gas supply to water heater and disconnect gas piping from gas control.
- Step 3. Disconnect wire harnesses & burner assembly from gas control.
- Step 4. Using gas control service tool (239-45991-00) available from your BWC parts supplier, Insert tool into back of gas control (see photos below)

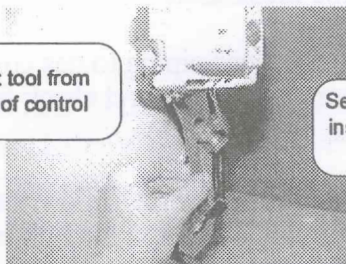
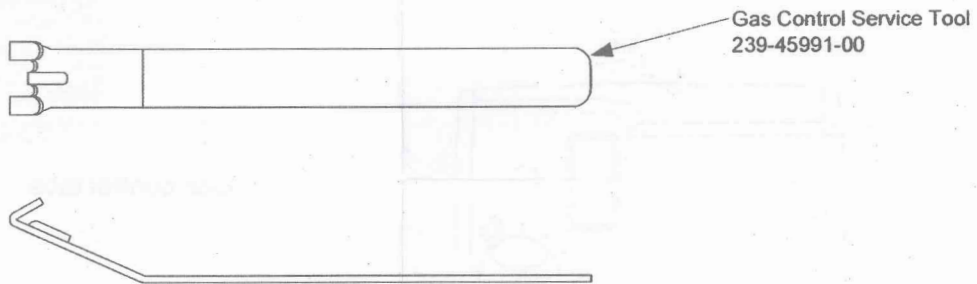

Insert tool from back of control

Service tool shown inserted in to back of control

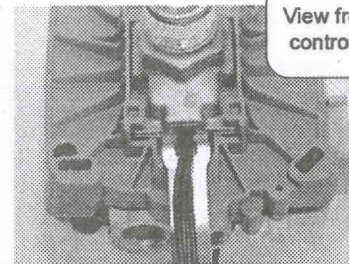
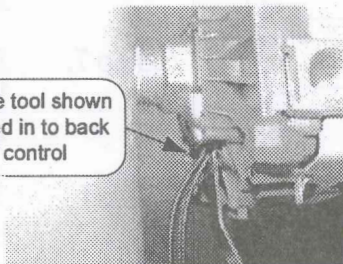

View from back of control for clarity

- Step 5. Pivot tool towards heater as far as possible (see photo below). Lift straight up on gas control. The control should move about 1/8". Hold control in position and remove tool. Lift straight up on control to remove completely from Thermal Well.

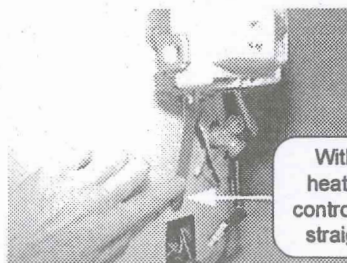

With service tool inserted, pivot tool back towards heater as far as possible. Lift straight up on control, control will move 1/8". Remove tool and continue to lift straight up on control to remove from Thermal Well.



69-2008

238-46005-00A (Rev 02/06)

Gas Control Assembly to Thermal Well

Step 1. With threaded end of thermal well installed into tank, be sure thermal well flange is positioned as shown in photo 24 for proper control alignment.

Step 2. Route wire leads back into relief opening. (see photo 24)

Step 3. Align slots located on thermal well flange with tabs located on back of gas control (see photos 24 & 25)

Step 4. Carefully push control back onto thermal well flange as far as possible towards water heater. Slide control down to lock into position.

Step 5. Install burner and connect pilot and feedline to gas control.

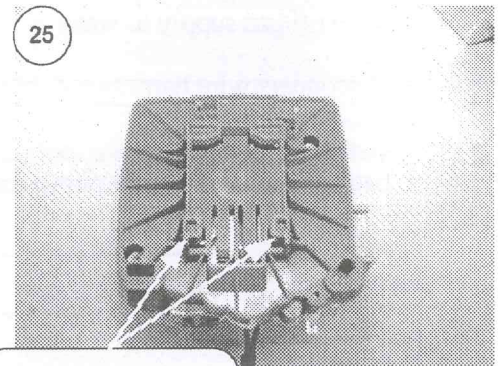
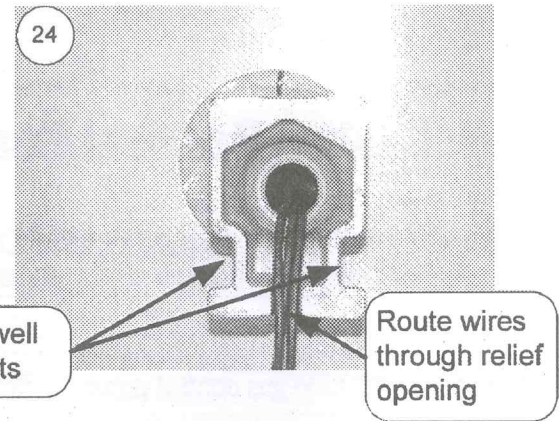

Gas control tabs

Step 6. Reconnect wire harnesses to gas control per the illustration.

Step 7. Reconnect gas piping to gas control. Restore gas supply and check for gas leaks.

Step 8. To resume operation, follow the instruction located on the lighting instruction label or the lighting instruction located in the installation and operation manual.

