



Incandescent

**Broadway Lights  
Deluxe**

**Bath & Vanity**

|       |                          |                          |                          |
|-------|--------------------------|--------------------------|--------------------------|
|       | Type _____               |                          |                          |
|       | -10                      | -15                      | -30                      |
| P3298 | <input type="checkbox"/> | <input type="checkbox"/> | <input type="checkbox"/> |
| P3299 | <input type="checkbox"/> | <input type="checkbox"/> | <input type="checkbox"/> |
| P3300 | <input type="checkbox"/> | <input type="checkbox"/> | <input type="checkbox"/> |

| Catalog No. | Finish         |                 |       | Lamping   | Dimensions (Inches) |       |
|-------------|----------------|-----------------|-------|-----------|---------------------|-------|
|             | Polished Brass | Polished Chrome | White |           | A                   | B     |
| P3298       | -10            | -15             | -30   | 4 (m) 60w | 24                  | 4-1/4 |
| P3299       | -10            | -15             | -30   | 6 (m) 60w | 36                  | 4-1/4 |
| P3300       | -10            | -15             | -30   | 8 (m) 60w | 48                  | 4-1/4 |

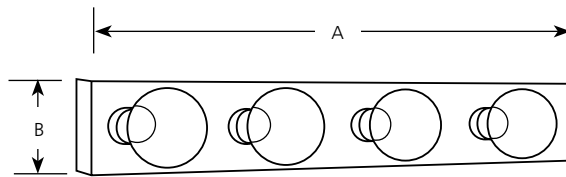

**P3298**

**Specifications:**

General

- Polished Brass (-10), Polished Chrome (-15) and White (-30) face plates available
- Steel construction
- Sockets are covered with matching socket cups
- Socket spacing is 6" on centers
- Medium based G lamps recommended

Electrical

- Medium based phenolic sockets
- Pre-wired with sockets in place

Labeling

- UL-CUL listed

Mounting

- Wall mount
- Ceiling mount only with 25 watt lamps
- Full length back plate covers outlet box
- Unit can be direct wired without outlet box

Progress Lighting  
701 Millenium Blvd.  
Greenville, South Carolina  
29607

www.progresslighting.com

Rev. 1/02



Incandescent

**Deluxe Broadway Lights**  
Aluminum Construction

**Bath & Vanity**

|       |                          |                          |
|-------|--------------------------|--------------------------|
|       | Type _____               |                          |
|       | -15                      | -30                      |
| P3298 | <input type="checkbox"/> | <input type="checkbox"/> |
| P3299 | <input type="checkbox"/> | <input type="checkbox"/> |
| P3300 | <input type="checkbox"/> | <input type="checkbox"/> |

| Catalog No. | Finish          |       | Lamping   | Dimensions (Inches) |       |
|-------------|-----------------|-------|-----------|---------------------|-------|
|             | Polished Chrome | White |           | A                   | B     |
| P3298       | -15             | -30   | 4 (m) 60w | 24                  | 4-1/4 |
| P3299       | -15             |       | 6 (m) 60w | 36                  | 4-1/4 |
| P3300       | -15             | -30   | 8 (m) 60w | 48                  | 4-1/4 |

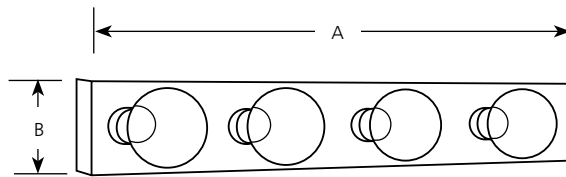

**P3298**

**Specifications:**

General

- Polished Chrome (-15) is a plated finish
- Aluminum face plate
- Sockets are covered with matching aluminum socket cups
- Back plate is protected steel
- Socket spacing is 6" on centers
- Medium based G lamps recommended

Electrical

- Pre-wired with sockets in place
- Medium based phenolic sockets

Labeling

- UL-CUL listed

Mounting

- Wall mounted
- Ceiling mount only using 25 watt lamps
- Full length back plate covers outlet standard 4" recessed octagonal outlet box
- Unit can be direct wired without an outlet box

Progress Lighting  
701 Millenium Blvd.  
Greenville, South Carolina  
29607

www.progresslighting.com