



## Installation, Operation & Maintenance Instructions for the PRIER Mansfield Style 400 Diamond Series Wall Hydrant

\*Please leave this sheet for the property homeowner\*

Thank you for purchasing the PRIER Mansfield Style 400 Diamond Series Wall Hydrant. Your 400 Diamond Series Wall Hydrant will provide you years of dependable service with little or no maintenance.

### Installation:

Installation procedures may vary slightly depending on the seat option purchased and the installation inlet options. PRIER Mansfield Style 400 Series wall hydrants are available with the following inlet options:

478-D Style	1/2" MIP x 1/2" SWT	Bore 1" Hole
479-T Style	3/4" MIP x 1/2" FIP	Bore 1 1/8" Hole
481-S Style	1/2" SWT x 3/4" Push-On	Bore 1" Hole
482-F Style	3/4" MIP x 3/4" SWT	Bore 1 1/8" Hole
490-X Style	1/2" Crimp PEX	Bore 1" Hole
491-W Style	1/2" Wirsbo PEX	Bore 1" Hole
492-FX Style	3/4" Crimp PEX	Bore 1 1/8" Hole
493-FW Style	3/4" Wirsbo PEX	Bore 1 1/8" Hole

1. Determine the location for the installation of the hydrant. The valve must be installed into an area of the structure that will not drop below freezing. Ensure there is adequate work room in the interior of the structure for securing the hydrant to the plumbing piping. Bore the hole size listed above through the wall in the desired position for the installation.
2. All freezeless wall hydrants require a slight downward pitch to aid the draining process of the hydrant once the product is turned to the "off" position. PRIER has included an appropriate siding wedge to install behind the wall flange of the hydrant. This ensures proper drainage pitch results after installation.
3. Position the spout of the hydrant in the downward position. From the interior of the structure, utilize the spout aligning mark on the seat. When the mark is pointed down, the spout is oriented in the proper position on the outside of the structure.
4. If you are planning to solder the connection (478, 481 or 482 style seats), be certain the hydrant is in the fully open position to prevent seat damage from the heat.
5. Connect the water supply piping to the freezeless wall hydrant as desired. With a closed-end hose attached, test the installation for leakage.
6. After the water supply connection is made, secure the hydrant to the structure using appropriate screws through the two mounting holes on the casted back flange and siding wedge.

### Operation:

Operation of the PRIER Mansfield Style 400 Diamond Series Wall Hydrant is a simple process. Water flows through the hydrant after turning the handle counter-clockwise to the "on" position. Turn off the hydrant by turning the handle clockwise to the "off" position.

The hydrant will drain for a few moments. If the dripping persists after a few moments, tighten the handle slightly until the dripping stops. Be careful not to overtighten the hydrant.

The 400 Series incorporates an integral atmospheric anti-siphon vacuum breaker that, in the rare occurrence of a back siphonage, opens to the atmosphere preventing contamination of the water supply.

As well as an atmospheric vacuum breaker, the 400 Series incorporates a backflow preventer that operates as a check valve in the rare case that water is forced backwards into the valve. The backflow preventer has been tested to 125 PSI pressure.

**\*ALWAYS REMOVE HOSE DURING FREEZING TEMPERATURES\***  
**\*INTENDED FOR IRRIGATION USE AND OUTDOOR WATERING\***



**Maintenance:**

The PRIER Mansfield Style 400 Diamond Series Wall Hydrant leaves the factory fully air tested and operational. It is treated with an FDA approved lubrication. The hydrant requires no scheduled maintenance to provide long life.

**Parts for Mansfield Style 400 Diamond Series Wall Hydrant**

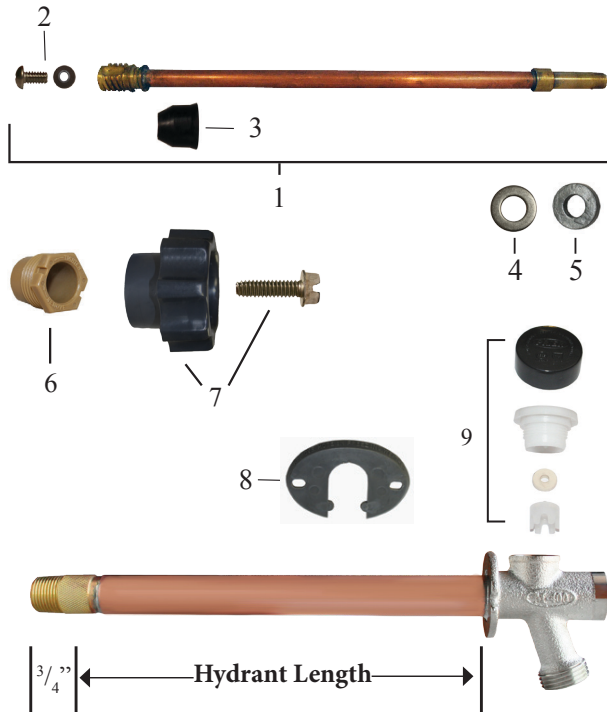

ID	Part No.	Description
1	See Chart Below	Stem Assembly
2	C-134KT-802	Seat Washer Replacement Kit-00 Beveled
3	336-0002	Backflow Check Valve for 400 Series
4	324-1006	Washer-Stainless Steel
5	339-3002	Packing Washer-Graphite
6	337-3001	Packing Nut, Left Hand Thread-Plastic
7	630-7965	Plastic Handle & Stainless Steel Screw Kit-Grey
	630-7975	Plastic Handle & Stainless Steel Screw Kit-Beige
8	337-3012	Space Wedge-Plastic, Grey
9	630-7500	Vacuum Breaker Replacement Kit
2,3,4,5,6	630-7755	Service Kit for 300/400/500

**Replacement Stems for Mansfield Style 400 Diamond Series Wall Hydrant**



Part No.	Style	Description	Stem Length
231-3204	H	Stem for 4" 400 Series Hydrant	6 <sup>9</sup> / <sub>16</sub> " OAL
231-3206	H	Stem for 6 " 400 Series Hydrant	8 <sup>9</sup> / <sub>16</sub> " OAL
231-3208	H	Stem for 8" 400 Series Hydrant	10 <sup>9</sup> / <sub>16</sub> " OAL
231-3210	H	Stem for 10" 400 Series Hydrant	12 <sup>9</sup> / <sub>16</sub> " OAL
231-3212	H	Stem for 12" 400 Series Hydrant	14 <sup>9</sup> / <sub>16</sub> " OAL
231-3214	H	Stem for 14" 400 Series Hydrant	16 <sup>9</sup> / <sub>16</sub> " OAL