

PROVENT

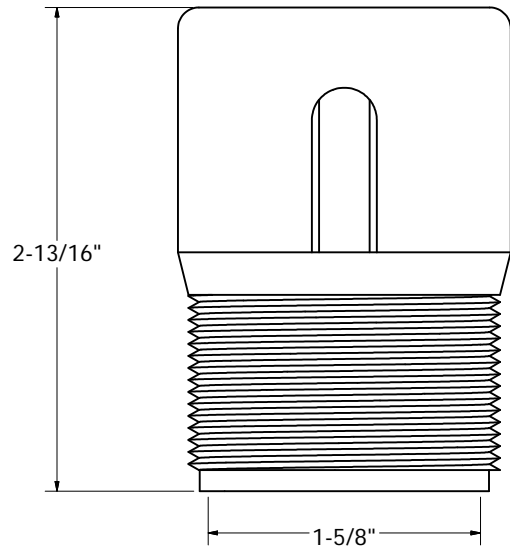

- MANUFACTURED HOUSING AND RV'S ONLY
- AUTOMATIC ANTI-SIPHON TRAP VENT
USED AS SECONDARY VENTING
- MUST BE LOCATED AT LEAST 60" ABOVE
TRAP ARM
- TWO INDIVIDUALLY PROTECTED FIXTURES
MAY BE CONNECTED TO SAME 1-1/2" DRAIN
- THREE OR MORE FIXTURES MUST BE
DRAINED BY 2" LINE
- SIMPLY HAND TIGHTEN, NO THREAD SEAL
NEEDED
- WATER CLOSET MUST HAVE MAIN STACK
TO OUTSIDE
- MUST BE INSTALLED IN ACCESSIBLE
LOCATION WITH FREE FLOW AIR
- DO NOT INSTALL IN SEALED WALL CAVITY
- 1-1/2" MPT THREADS

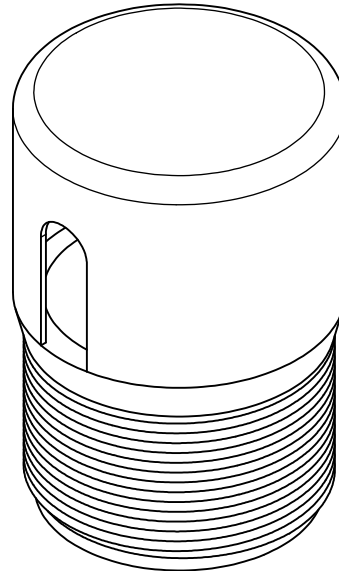
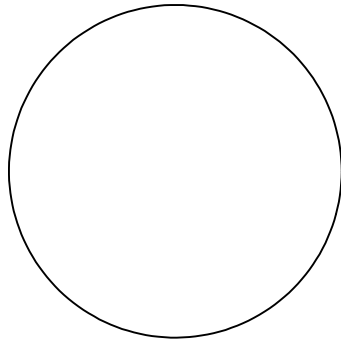

PHONE NUMBER
1-800-355-6637
FAX NUMBER
1-800-462-6991
SCALE 1.75 : 1 DATE 3-07-13
SHEET **1 OF 1**
DRAWN BY
ASHLEY KRALOVEC

PART NO.	P21150
DESCRIPTION	1-1/2" PROVENT
MATERIAL	1/50