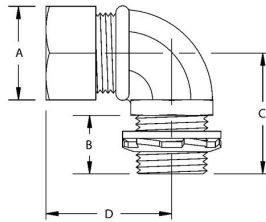

**90 DEGREE CONDUIT AND CORD CONNECTORS - STEEL/MALLEABLE IRON****90 Degree Connectors Steel/Malleable Iron****B48**

Catalog #: 3426

**APPLICATIONS**

For use in outdoor or indoor locations on flexible metallic liquidtight conduit and Type B flexible nonmetallic liquidtight conduit  
 Use to positively bond the conduit to a box or enclosure

**PRODUCT FEATURES**

RACO liquidtight connectors are suitable for use in Class I, Div. 2, Class II, Div. 1 & 2; and Class III, Div. 1 & 2 hazardous locations  
 Patented split gland-ring is designed to slip onto the conduit quickly gripping the jacket of the conduit, speeding installation, assuring a perfect seal, and preventing pullouts  
 All components are reusable - RACO liquidtight connectors may be easily disassembled and reused after years of service  
 Sealing washer (included) provides a liquidtight seal when terminating the connector in a threadless opening  
 Heavy duty locknut included with every RACO liquidtight connector assures continuity of ground  
 UPC bar coded fittings are individually polybagged with a preprinted UPC-A bar code, and packaged in pre-scored tear top cartons for an attractive presentation  
 All steel/iron components are zinc electro plated for added corrosion protection  
 3/8 in. to 1 in. Steel bodies, 1-1/4 in. to 4 in. Malleable iron bodies  
 3/8 in. to 1 in Steel nuts, 1-1/4 in. to 4 in. Malleable iron nuts

**UL LISTED**

Standard 514B, UL Listed E195969

**CSA**

C22.2 No. 18

**GENERAL PRODUCT INFORMATION**

Sub Class: Uninsulated  
 Trade Size: 1-1/2 in.

**DRAWING DIMENSIONS**

Dimension A: 2-13/32 in.  
 Dimension B: 49/64 in.  
 Thread Spec. B: 1-1/2 in. - 11-1/2 NPT  
 Dimension C: 2-1/4 in.  
 Dimension D: 2-5/8 in.

**PACKAGING**

Package Type: Carton  
 Ship Carton Qty.: 5  
 Product UPC-A Labeled: No  
 Weight (Lbs. Per/C): 136  
 Ship Carton Length (in.): 8  
 Ship Carton Width (in.): 7  
 Ship Carton Height (in.): 4.625  
 Ctn Weight (Lbs.): 6.8  
 UPC Number: 050169034262  
 I2of5: 50050169034267