

### PEXRITE POP-UP™ – #708

- Double run PEXRITE POP-UP for in-slab flexible tubing support
- Manifold capability with interlocking feet
- Compatible with PEX, soft Copper, flexible conduit
- Unique design allows for side-entry of tubing
- Mounts to form decking or slab-on-grade with rebar

Model#	Size	For Pipe Size(s)	Box Qty
708	10-1/2" X 11-1/8" X 2-1/2"	3/8" thru 1-1/8" O.D.	15

**NEW**

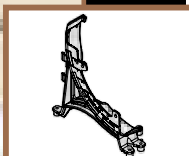
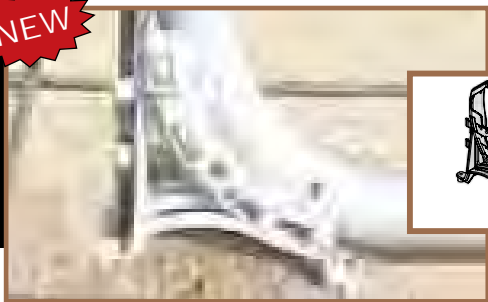

### PEXRITE POP-UP™ – #708-E

- Double run PEXRITE POP-UP for in-slab PEX tubing, flexible conduit, & rigid conduit 90s.
- Unique design allows for easy zip tie installation
- Mounts to form decking or slab-on-grade with rebar
- Manifold capability with interlocking feet

Model#	Size	For Pipe Size(s)	Box Qty
708-E	10-1/2" x 11-1/6" x 3-1/4"	3/8" thru 2-1/2" IPS	15

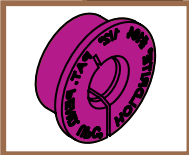
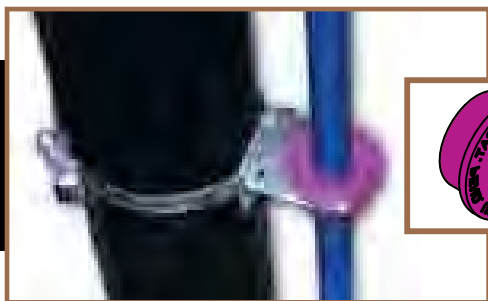

### HOLDRITE INSERTS – #104 - #106

- Ideal for pipe support with HOLDRITE #121 & #103 series brackets
- Compatible with PEX, Copper, and CPVC tubing

Model#	Hole Needed	For Pipe Size(s)	Box Qty
104	1-3/8" Diameter	1/2" CTS	100
105	1-3/8" Diameter	3/4" CTS	100
106	1-3/8" Diameter	1" CTS	100

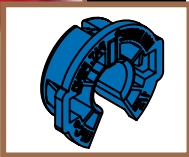

### HOLDRITE INSERTS – #404-R - #406-R

- Ideal for metal studs with PEX, Copper, and CPVC tubing
- Integrates with most HOLDRITE galvanized brackets
- Flame-rated per UL 94 V-2 standards
- Fits in 1-3/8" or 1-11/32" holes

Model#	Hole Needed	For Pipe Size(s)	Box Qty
404-R	1-3/8" Diameter	1/2" CTS	100
405-R	1-3/8" Diameter	3/4" CTS	100
406-R	1-3/8" Diameter	1" CTS	100

**NEW**

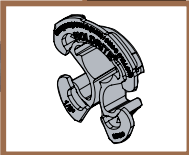

### HOLDRITE ISOLATORS – #424 - #426

- Ideal for metal thru-stud applications and integrates with HOLDRITE #121 and #125 series brackets
- Positioning and dissimilar metal isolation for Copper, CPVC, and PEX tubing
- Meets UL 94 HB requirements

Model#	Hole Size	Pipe Size	Bag Qty	Master Carton Qty
424	1-11/32" & 1-3/8"	1/2" CTS	50	250
425	1-11/32" & 1-3/8"	3/4" CTS	50	250
426	1-11/32" & 1-3/8"	1" CTS	50	250

# Isolators and Clamps

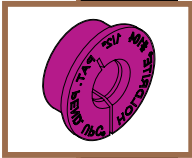

## HOLDRITE ISOLATORS – #104 - #106

- Ideal for Copper, PEX, and CPVC tubing in stub-out locations with #103 series, #121 series, and #110-R brackets
- Compatible with #121 series brackets for other applications
- Tubing size up to 1"

Model#	Hole Needed	For Pipe Size(s)	Box Qty
104	1-3/8" Diameter	1/2" CTS	100
105	1-3/8" Diameter	3/4" CTS	100
106	1-3/8" Diameter	1" CTS	100

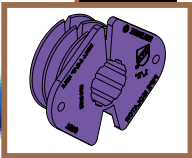

## HOLDRITE THRU-STUD ISOLATORS – #161 - #163

- Ideal for thru-stud applications in wood or metal framing (1-3/8" or 1-11/32" holes)
- Ideal for isolation of Copper, PEX, and CPVC tubing
- Tubing size up to 1"

Model#	For Pipe Size(s)	Bag Qty	Master Carton Qty
161	1/2" CTS	50	500
162	3/4" CTS	50	500
163	1" CTS	25	250

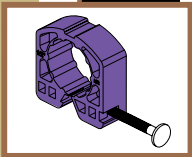

## HOLDRITE SINGLE-NAIL CLAMPS – #181 - #183

- Ideal for clamp installation for Copper, PEX, and CPVC tubing
- Pre-installed nail for quick installation
- Tubing size up to 1"

Model#	For Pipe Size(s)	Bag Qty	Master Carton Qty
181	1/2" CTS	100	1000
182	3/4" CTS	50	500
183	1" CTS	25	250

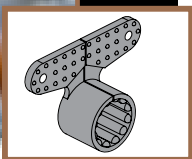

## HOLDRITE SUSPENSION CLAMPS – #221 - #226

- Ideal for Copper, PEX, and CPVC tubing
- Mounts directly on HOLDRITE STOUT BRACKET or other surfaces
- Tubing size up to 2"

Model#	Clamp Size	For Pipe Size(s)	Box Qty
221	1-7/8" X 1-1/2"	1/2" CTS	100
222	1-7/8" X 1-3/4"	3/4" CTS	100
223	2-3/8" X 2-1/8"	1" CTS	50
224	2-7/8" X 2-3/8"	1-1/4" CTS	25
225	2-7/8" X 2-3/4"	1-1/2" CTS	25
226	3-3/8" X 3-1/8"	2" CTS	25

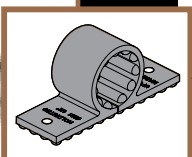

## HOLDRITE STANDARD CLAMPS – #231 - #236

- Ideal for Copper, PEX, and CPVC tubing
- Mounts directly on HOLDRITE STOUT BRACKET or other surfaces

Model#	Clamp Size	For Pipe Size(s)	Box Qty
231	2" X 7/8"	1/2" CTS	100
232	2-3/8" X 2-1/8"	3/4" CTS	100
233	2-3/4" X 2-1/2"	1" CTS	50
234	2-3/4" X 1-3/4"	1-1/4" CTS	25
235	3-1/8" X 2"	1-1/2" CTS	25
236	3-1/2" X 2-1/2"	2" CTS	25

Job Name _____	Date _____	P.O. # _____
Co. Name _____	Estimate# _____	
Address _____	Phone _____	
Contact _____		

MODEL #	QTY	DESCRIPTION	BOX QTY	CATALOG PAGE #
100-18		20" flat, Copper-Bonded bracket positions 1/2" tubing with unique mfg. process and design	100	15
101-18		20" flat, Copper-Bonded bracket positions 1/2" tubing	50	15, 40
101-18R		20" extruded holes, Copper-Bonded bracket positions 1/2" tubing	25	9, 15, 38
101-26		26" flat, Copper-Bonded bracket positions 1/2" tubing	50	15
101-26R		26" extruded holes, Copper-Bonded bracket positions 1/2" or 3/4" tubing	25	9, 15, 40
101-F		3" Copper-Bonded floor plate, supports one 1/2" tube	50	16
102-18		20" flat, Copper-Bonded bracket positions 3/4" or 1" tubing	50	15, 40
102-26		26" flat, Copper-Bonded bracket positions 1/2", 3/4" or 1" tubing	50	15, 40
103-18		20" flat, galvanized bracket with 1-3/8" keyed holes, positions 1/2" - 1" tubing	50	7, 8, 12, 38, 39, 44
103-26		26" flat, galvanized bracket with 1-3/8" keyed holes, positions 1/2" - 1" tubing	50	7, 8, 12, 38
104		1/2" plastic insert for use with #103 brackets	100	10, 19, 32, 41
105		3/4" plastic insert for use with #103 brackets	100	10, 32
106		1" plastic insert for use with #103 brackets	100	10, 32
107-18		20" flat, Copper-Bonded bracket positions 1/2", 3/4" or 1" tubing	50	15, 40
107-26		26" flat, Copper-Bonded bracket positions 1/2", 3/4", 1" or 1-1/4" tubing	50	15, 40
108-20		20" extruded holes, Copper-bonded bracket positions 1/2", 3/4" or 1" tubing	50	15
108-26		26" extruded holes, Copper-bonded bracket positions 1/2", 3/4" or 1" tubing	50	15
109-A-9		"L" bracket with six 1/2" extruded holes at 2-3/4", 4-1/2", 6", 7", 8" or 9"	50	16, 40
109-N-6		Copper-bonded steel bracket made to position 1/2" and 3/4" copper tubing	50	16, 40
110-R		Galvanized steel bracket for pipe-on-pipe support for 1/2", 3/4" or 1" tubing	50	8, 19, 38, 44
110-S-1/2		Copper-bonded bracket with 1/2" notches on 1" centers	50	18, 41
111-S		Copper-bonded bracket for 1/2" and 3/4" tubing	50	18, 41
114-C		Copper-bonded carrier bracket secures 1" flush valve stub out	6	19, 41
114-CEXT		Provides additional height of 8-1/2" to 25-1/2" for carrier brackets	6	19, 41
114-CO		Copper-bonded offset carrier bracket secures 1" flush valve stub out	6	19, 41
114-CR		Copper-bonded carrier bracket with 1-1/8" notch at the top	6	19, 41
115		Galvanized steel bracket secures 1/2" through 2" pipe	25	18, 41
115-C		Copper-bonded steel bracket secures 1/2" through 2" pipe	25	18, 41
117-3		Steel band with stainless steel clamps. 1-1/2" - 3" IPS. Ideal for cast iron DWV piping	5	18
117-6		Steel band with stainless steel clamps. 4" - 6" IPS. Ideal for cast iron DWV piping	5	18
117-8		Steel band with stainless steel clamps. 8" IPS. Ideal for cast iron DWV piping	5	18
117-3D		Steel band w/ stainless steel clamps. 1-1/2" - 3" IPS. Diagnol support-cast iron DWV piping	5	18
117-6D		Steel band w/ stainless steel clamps. 4" - 6" IPS. Diagnol support-cast iron DWV piping	5	18
117-8D		Steel band w/ stainless steel clamps. 8" IPS. Diagnol support-cast iron DWV piping	5	18
118-T6		Copper-bonded pipe on pipe support bracket- 1/2" & 3/4" (3/4" on 6" centers)	50	18, 41
118-T8		Copper-bonded pipe on pipe support bracket- 1/2" & 3/4" (3/4" on 8" centers)	50	18, 41
121		Galvanized steel bracket that supports one copper, PEX or CPVC tube	25	19, 41
121-D		Galvanized steel bracket that supports two lines of copper, PEX or CPVC tubing	25	22
121-DLS		Galvanized steel bracket that supports two lines of copper, PEX or CPVC tubing	25	22, 42
121-DS		Galvanized steel bracket that supports two lines of copper, PEX or CPVC tubing	25	22, 38, 39, 42
121-L		Galvanized steel bracket that supports two lines of copper, PEX or CPVC tubing	25	22, 42
121-O		Galvanized steel bracket that supports three lines of copper, PEX or CPVC tubing	25	23, 42
121-R		Galvanized steel bracket that supports one copper, PEX or CPVC tube	25	22, 42
121-RLS		Galvanized steel bracket that supports one copper, PEX or CPVC tube	50	22
121-W		Galvanized steel bracket that supports one copper, PEX or CPVC tube	25	22, 42
125		Concrete Insert Bracket with 121-R and 121-W Centerlines	50	23, 42
125-D		Concrete Insert Bracket with 121-D Centerlines	50	23, 42
130		Single solid copper clip for 1/2" tube	100	16
131		Single solid copper clip for 3/4" tube	100	16
132		Single solid copper clip for 1" tube	100	16
140		20" Copper-bonded bracket with extruded notches for 1/2" or 3/4" tubing	50	16, 40
141		20" Copper-bonded 90° bracket with extruded notches for 1/2" or 3/4" tubing	50	16
150-20		20" flat, Copper-bonded bracket positions 1/2" or 3/4" tubing	50	16, 40
150-26		26" flat, Copper-bonded bracket positions 1/2" or 3/4" tubing	50	16, 40
161		Plastic thru-stud isolator (1/2" CTS)	50	32, 38, 39, 40
162		Plastic thru-stud isolator (3/4" CTS)	50	32
163		Plastic thru-stud isolator (1" CTS)	25	32
170		18" 90° galvanized steel bracket	50	16
170-251		18" galvanized brackets and #251 variable closure clamps (BULK PACKAGING)	25/50	13
170-C		18" 90° Copper-bonded bracket	50	16
170-S		18" 90° galvanized steel bracket with two screws	50	16
181		Plastic single nail clamp (1/2" CTS)	100	32, 38, 39
182		Plastic single nail clamp (3/4" CTS)	50	32
183		Plastic single nail clamp (1" CTS)	25	32
201		Strong quick-closing plastic clamp for single 1/2" tube	50	26
202		Strong quick-closing plastic clamp for single 3/4" tube	50	26