

THE INFORMATION CONTAINED IN THIS DRAWING IS THE SOLE PROPERTY OF GREENFIELD MFG CO ANY REPRODUCTION IN PART OR WHOLE WITHOUT THE WRITTEN PERMISSION OF GREENFIELD MFG CO IS PROHIBITED.

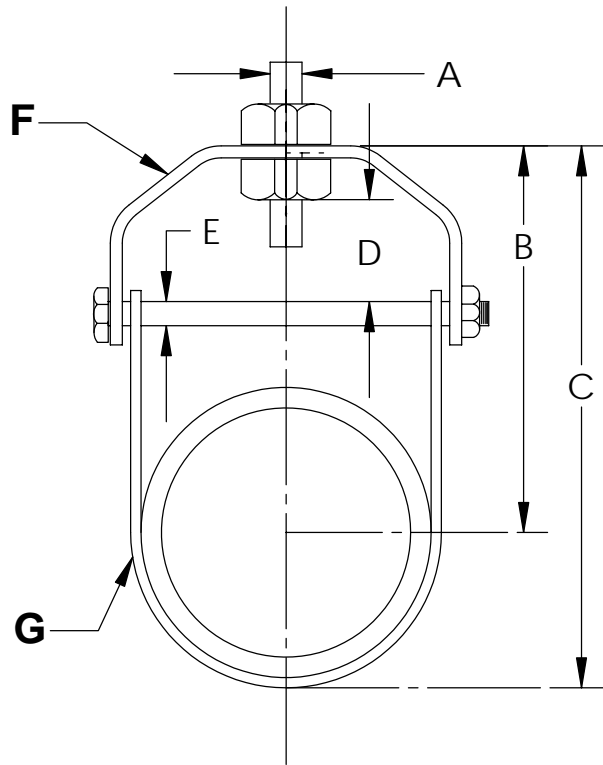

| SIZE | A | B | C | D | E | F | G | MAX REC LOAD (lbs) |
|-------|-----|------|------|------|------|--------------|--------------|--------------------|
| 1/2 | 3/8 | 1.7 | 2.5 | 0.62 | 1/4 | .080 X 1.00 | .070 X 1.00 | 250 |
| 3/4 | 3/8 | 2.0 | 2.8 | 0.62 | 1/4 | .080 X 1.00 | .070 X 1.00 | 250 |
| 1 | 3/8 | 2.3 | 3.0 | 0.62 | 1/4 | .080 X 1.00 | .070 X 1.00 | 250 |
| 1-1/4 | 3/8 | 2.5 | 3.5 | 0.75 | 1/4 | 13 ga X 1.00 | .070 X 1.00 | 250 |
| 1-1/2 | 3/8 | 2.8 | 3.8 | 1.00 | 1/4 | 12 ga X 1.00 | .070 X 1.00 | 250 |
| 2 | 3/8 | 3.0 | 4.0 | 1.30 | 1/4 | 12 ga X 1.00 | .080 X 1.00 | 300 |
| 2-1/2 | 1/2 | 3.5 | 5.3 | 1.30 | 5/16 | 11 ga X 1.25 | 13 ga X 1.25 | 350 |
| 3 | 1/2 | 4.8 | 7.0 | 2.00 | 5/16 | 11 ga X 1.25 | 13 ga X 1.25 | 350 |
| 4 | 1/2 | 5.8 | 8.0 | 2.00 | 3/8 | 8 ga X 1.25 | 11 ga X 1.25 | 500 |
| 5 | 5/8 | 6.5 | 9.5 | 2.30 | 1/2 | 3 ga X 1.25 | 8 ga X 1.25 | 700 |
| 6 | 3/4 | 7.5 | 10.5 | 2.30 | 1/2 | 3 ga X 1.50 | 8 ga X 1.50 | 800 |
| 8 | 3/4 | 8.8 | 13.0 | 2.30 | 9/16 | 3 ga X 1.75 | 8 ga X 1.75 | 1500 |
| 10 | 7/8 | 10.0 | 15.0 | 2.30 | 3/4 | 3/8 X 1.75 | 3 ga X 1.75 | 2500 |
| 12 | 7/8 | 11.0 | 18.0 | 2.60 | 3/4 | 3/8 X 2.00 | 3 ga X 2.00 | 3500 |

Complies with Manufacturers Standardization Society
MSS-SP-58 Type-1 and WWH-171E Type-1

MADE IN USA

| | | | | |
|---|--|----------|----------------------------------|---------------|
| UNLESS OTHERWISE SPECIFIED DIMENSIONS ARE IN INCHES TOLERANCES ARE: FRACTIONS DECIMALS ANGLES +/- 1/8 .XX +/- .03 .XX + 1 .XXX +/- .01 | CAD GENERATED DRAWING, DO NOT MANUALLY UPDATE | | GREENFIELD MFG CO | |
| | APPROVALS | DATE | 920 LEVICK ST , PHILA.,PA. 19111 | |
| MATERIAL STEEL | DRAWN | EG | 5/13 | |
| | CHECKED | SB | CLEVIS -STANDARD | |
| DO NOT SCALE DRAWING | A | P/N | FIG 204 | REV. C |
| | SCALE | CAD FILE | 204.SLDDRW | SHEET OF |