

THE INFORMATION CONTAINED IN THIS DRAWING IS THE SOLE PROPERTY OF GREENFIELD MFG CO ANY REPRODUCTION IN PART OR WHOLE WITHOUT THE WRITTEN PERMISSION OF GREENFIELD MFG CO IS PROHIBITED.

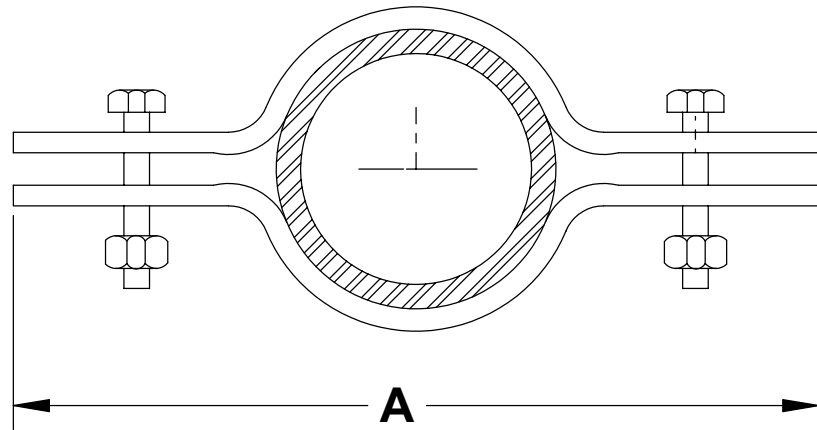

SIZE	A	STOCK	BOLT	MAX REC LOAD
1/2	8.63	1/8 X 1.00	5/16 X 1.00	220
3/4	8.82	1/8 X 1.00	5/16 X 1.00	220
1	9.06	1/8 X 1.00	5/16 X 1.00	220
1-1/4	9.50	1/8 X 1.00	5/16 X 1.25	250
1-1/2	10.00	5/32 X 1.00	5/16 X 1.25	250
2	10.50	5/32 X 1.00	3/8 X 1.50	300
2-1/2	11.12	1/4 X 1.00	3/8 X 1.50	400
3	11.50	1/4 X 1.00	3/8 X 1.75	500
4	13.00	1/4 X 1.00	7/16 X 1.50	600
5	14.00	1/4 X 1.25	1/2 X 2.00	1200
6	15.00	1/4 X 1.50	1/2 X 2.00	1600
8	18.50	3/8 X 1.50	5/8 X 2.50	2500
10	21.00	3/8 X 2.00	5/8 X 2.50	2500
12	23.00	1/2 X 2.00	5/8 X 2.50	2700

Made in USA

Complies with MSS-SP-58 Type 8

UNLESS OTHERWISE SPECIFIED DIMENSIONS ARE IN INCHES TOLERANCES ARE: FRACTIONS DECIMALS ANGLES +/- 1/8 .XX +/- .03 .XX + 1 .XXX +/- .01		CAD GENERATED DRAWING, DO NOT MANUALLY UPDATE		GREENFIELD MFG CO	
MATERIAL CQ STEEL		APPROVALS	DATE	920 LEVICK ST , PHILA.,PA. 19111	
		DRAWN EG			
DO NOT SCALE DRAWING		CHECKED SB		P/N RISER CLAMP	
		7/13		A	FIG 108
		SCALE	CAD FILE:	SHEET OF	