

**READ AND UNDERSTAND THESE INSTRUCTIONS BEFORE INSTALLING FIXTURE**

This fixture is intended for installation in accordance with the National Electrical Code and local regulations. To assure full compliance with local codes and regulations, check with your local electrical inspector before installation. To prevent electrical shock, turn off electricity at fuse box before proceeding.

**Retain these instructions for maintenance reference.**

**INSTRUCTION SHEET NO.**

**IS:3R**

**C0400 Page 1 of 1**

**INSTALLATION PROCEDURE FOR REMODELER KITS  
2003R (3 3/4"), 1003R (5"), 1103R (6 3/4")**

**FOR USE WITH LYTECASTER 2000 SERIES, 1000 SERIES OR 1100 SERIES TRIMS (FINISHING SECTIONS) ONLY**

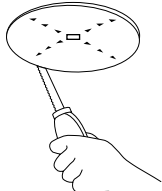

**1. CUT OPENING**

Use aperture sticker provided as a template to cut a hole in the ceiling. Cut to outside edge of sticker.

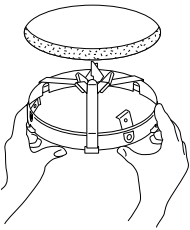
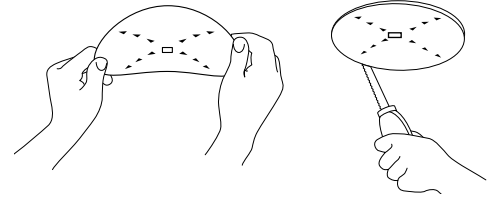

**2. ATTACH MOUNTING RING**

Push MOUNTING RING into opening until FLANGE sits against ceiling making sure "J-BOX" SLOT is in a position that will ensure enough space above ceiling for the J-BOX to sit flat against ceiling (see Step 4). Slide MOUNTING STRAPS down to trap ceiling thickness and then bend up to secure.

**Note:** When installing 2003R, Wire-In and push J-BOX through ceiling opening before attaching MOUNTING RING.

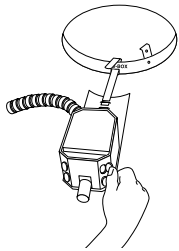
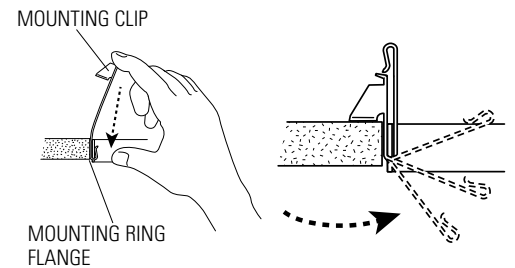

**3. WIRE-IN**

With 1103R and 1003R Remodeler Kits, the J-BOX can be hung temporarily from MOUNTING RING to assist with wire-in. Open hinged KNOCKOUT to allow NON-METALLIC CABLE to enter JUNCTION BOX. Push CABLE through CLAMP.

**Note:** Wiring and connections must not be placed in JUNCTION BOX in a manner which will interfere with the CLAMPS action to provide strain relief.

Wire to SUPPLY LEADS. WHITE FIXTURE LEAD to NEUTRAL SUPPLY LEAD. BLACK FIXTURE LEAD to HOT (120V) SUPPLY LEAD. BARE FIXTURE WIRE to SUPPLY GROUND. Use wirenuts (local hardware item). Place all electrical connections in the J-BOX and close the J-BOX COVER.

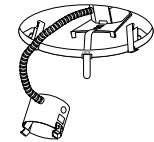
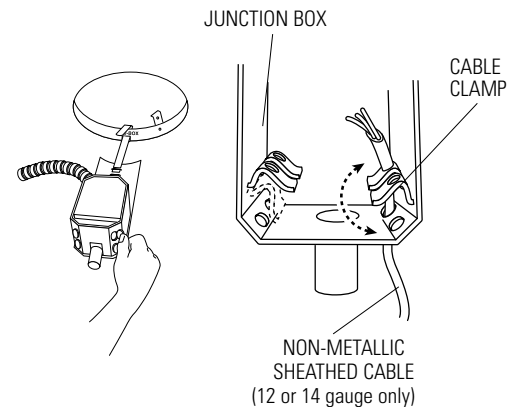

**4. ATTACH J-BOX**

Insert J-BOX MOUNTING STRAP between the ceiling material and MOUNTING RING and through the "J-BOX" SLOT on the MOUNTING RING. Pull the STRAP until the J-BOX PLATE sits flat on the ceiling with the feet over the edge of the ceiling thickness.

Bend J-BOX PLATE MOUNTING STRAP up to secure.

Make sure that the J-BOX PLATE is securely attached to the ceiling and the J-BOX is in the position shown.

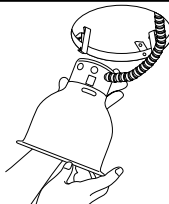
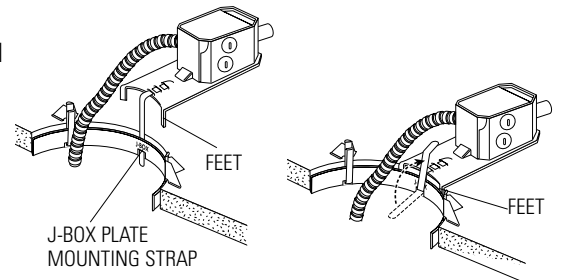

**5. SNAP-ON**

**6. PUSH-UP**

SEE SEPARATE REFLECTOR TRIM INSTRUCTION SHEETS.

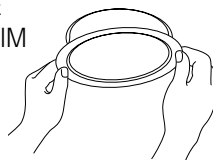

**WARNING: (RISK OF FIRE) DO NOT INSTALL INSULATION WITHIN 3" OF FIXTURE SIDES OR WIRING COMPARTMENT, NOR ABOVE FIXTURE IN SUCH A MANNER SO AS TO ENTRAP HEAT.**

U.S. PAT. NO. 5,957,572  
FOREIGN PATENTS PENDING

**LIGHTOLIER®**

**LIGHTOLIER a GENLYTE company.**

631 Airport Road, Fall River, MA 02720