

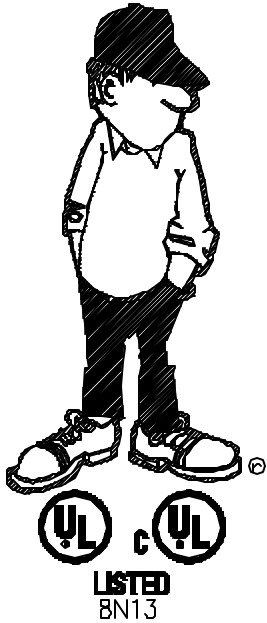

METAL AND WOOD STUD AND FLANGES UP TO 1/16"

INSTALLATION INSTRUCTIONS



MAC2
MC/AC
SUPPORT
CLIPS

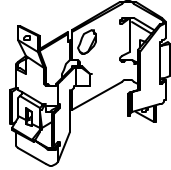

FOR CABLE SIZES
14-2 THROUGH 10-3
WITH GROUND

SEE REVERSE SIDE FOR
INSTALLATION INSTRUCTIONS

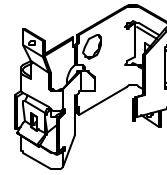
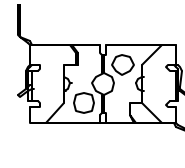
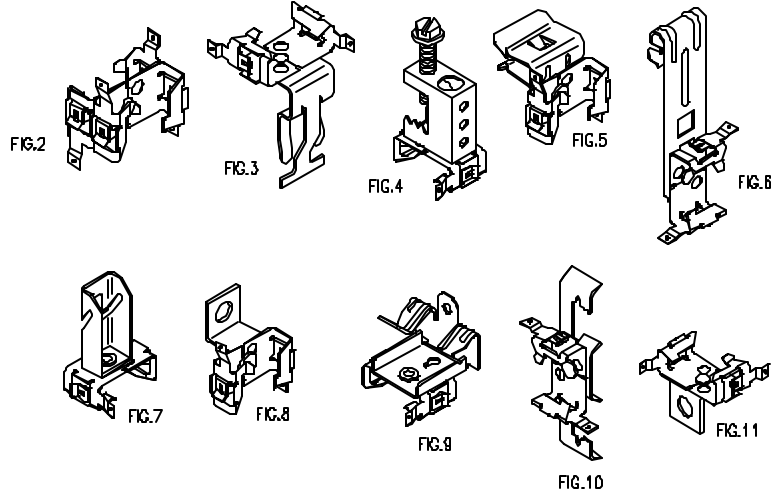

FIG.1



DOUBLE RUNS OF MC/AC CABLE FROM
STRUCTURAL MEMBERS, WIRES & RODS



SIZING CHART

* NOTE: MAC2 SNAPS APART FOR SINGLE CABLE APPLICATIONS
ASSEMBLIES DO NOT HAVE THIS FEATURE.

UPC NUMBER 782856-	CADDY PART NUMBER	FIG. NO.	DESCRIPTION	ATTACHES MC/AC TO:
32673	MAC2	1	METAL OR WOOD STUD AND 1/16" FLANGE	
33066	MAC2T	2	SUPPORT 1 TO 4 RUNS OF MC/AC CABLE FOR METAL STUD	
33067	MAC2ATA	3	ACOUSTICAL TEE	
33068	MAC2BC	4	1/8" THRU 1/2" FLANGE	
33069	MAC224SM	5	1/8" THRU 1/4" FLANGE	
33070	MAC258SM	5	5/16" THRU 1/2" FLANGE	
33071	MAC2912SM	5	1/2" THRU 3/4" FLANGE	
33072	MAC2VF14	6	1/16" THRU 1/4" C PURLIN OR VERTICAL FLANGE	
33073	MAC2123	7	Z PURLIN	
33074	MAC2AO	8	OFFSET BRACKET	
33075	MAC224	9	1/8" THRU 1/4" FLANGE - BOTTOM MOUNT ROTATES 360°	
33076	MAC258	9	5/16" THRU 1/2" FLANGE - BOTTOM MOUNT ROTATES 360°	
33077	MAC2912	9	9/16" THRU 3/4" FLANGE - BOTTOM MOUNT ROTATES 360°	
33078	MAC24Z34	10	#12 THRU 1/4" WIRE, PLAIN OR THREADED ROD & 1/8" THRU 3/8" FLANGE	
33079	MAC26Z34	10	3/8" PLAIN OR THREADED ROD AND 3/8" THRU 9/16" FLANGE	
33080	MAC2FB	11	THROUGH METAL STUD	

NOTE: FASTENERS AND ASSEMBLIES ARE PACKED 100 PER BOX

BOTTOM MOUNT FLANGE CLIPS

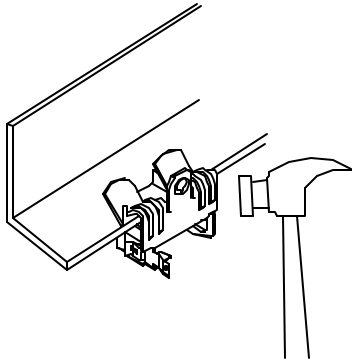

1. WITH HAMMER, TAP CLAMP ONTO FLANGE.

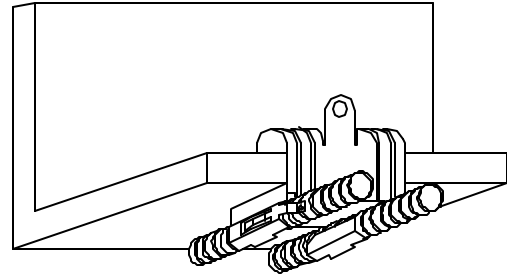
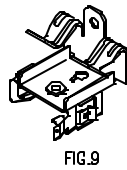

2. PRESS MC/AC CABLE INTO CLIP.

SIZING CHART

UPC NUMBER 782856-	CADDY PART NUMBER	FIG. NO.	DESCRIPTION
33075	MAC224	9	1 OR 2 RUNS MC/AC TO 1/8" THRU 1/4" FLANGE BOTTOM MOUNT ROTATES 360°
33076	MAC258	9	1 OR 2 RUNS MC/AC TO 5/16" THRU 1/2" FLANGE BOTTOM MOUNT ROTATES 360°
3077	MAC2912	9	1 OR 2 RUNS MC/AC TO 1/2" THRU 3/4" FLANGE BOTTOM MOUNT ROTATES 360°

BEAM CLAMP

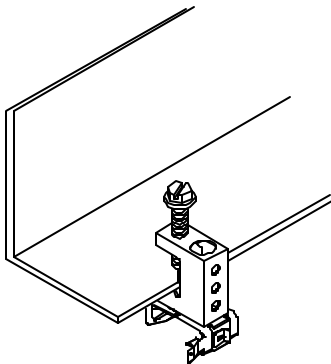

1. PLACE ON BEAM AND TIGHTEN SCREW SECURELY.
(APPROX. 20 IN. LBS. TORQUE.)

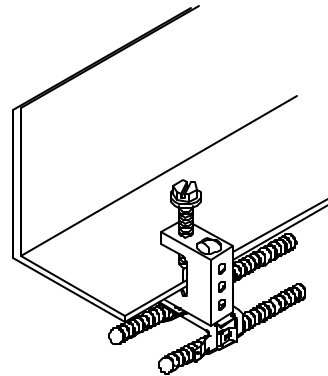
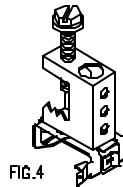

2. PRESS MC/AC CABLE INTO CLIP.

SIZING CHART

UPC NUMBER 782856-	CADDY PART NUMBER	FIG. NO.	DESCRIPTION
33068	MAC2BC	4	1 OR 2 RUNS OF MC/AC TO 1/8" THRU 1/2" FLANGE

TEE GRID

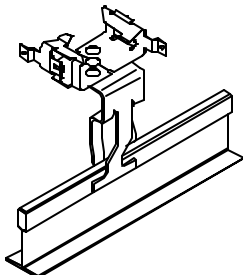

1. PLACE INVERTED "T" TAB AGAINST ACOUSTICAL TEE BAR.
2. PUSH CURVED TABS BACK OVER ON OPPOSITE SIDE OF TEE BAR AND PUSH DOWN.

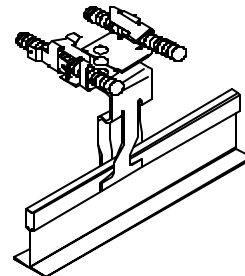
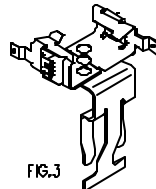

3. PRESS MC/AC CABLE INTO CLIP.

SIZING CHART

UPC NUMBER 782856-	CADDY PART NUMBER	FIG. NO.	DESCRIPTION
33067	MAC2ATA	3	1 OR 2 RUNS OF MC/AC TO ACOUSTICAL TEE BAR

PARALLEL TO STUD AND UP TO 1/8" FLANGE.

FLANGE APPLICATION

METAL AND WOOD STUDS

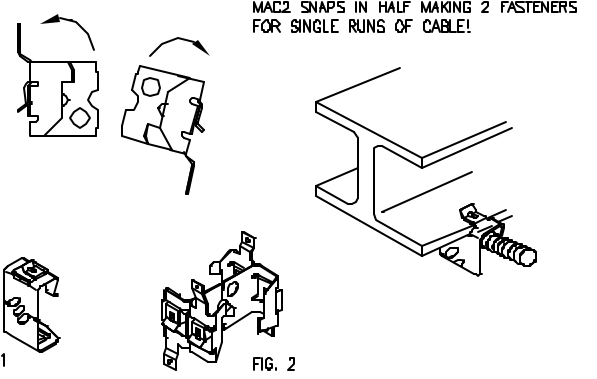
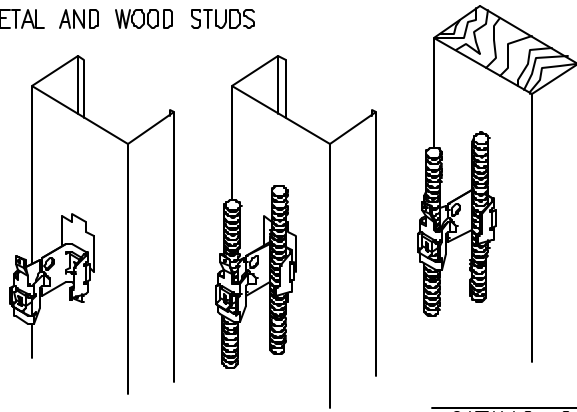

1. SNAP CLIP ONTO METAL STUD OR SCREW CLIP TO WOOD STUD.
2. PRESS MC/AC CABLE INTO CLIP.

SIZING CHART

UPC NUMBER 782856-	CADDY PART NUMBER	FIG. NO.	DESCRIPTION
32673	MAC2	1	METAL OR WOOD STUD AND 1/4" FLANGE
33066	MAC2T	2	1 TO 4 RUNS OF MC/AC TO METAL STUD

THROUGH METAL STUD

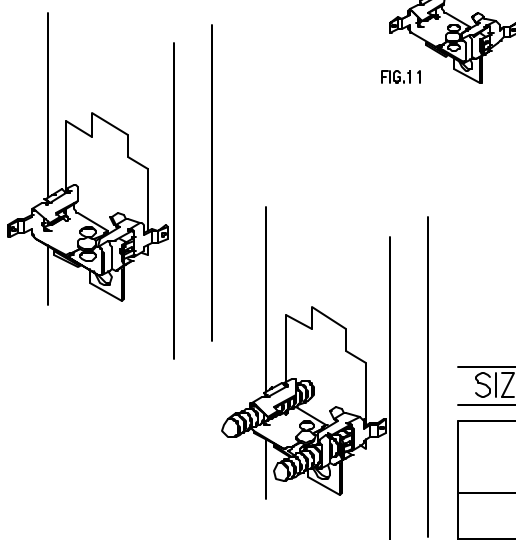

OFFSET BRACKET

1. NAIL OR SCREW CLIP TO STRUCTURE.
2. PRESS MC/AC CABLE INTO CLIP.

SIZING CHART

UPC NUMBER 782856-	CADDY PART NUMBER	FIG. NO.	DESCRIPTION
33080	MAC2FB	11	1 OR 2 RUNS OF MC/AC THRU METAL STUD
33074	MAC2AO	8	OFFSET BRACKET FOR 1 OR 2 RUNS OF MC/AC CABLE

SIDE MOUNT FLANGE CLIPS

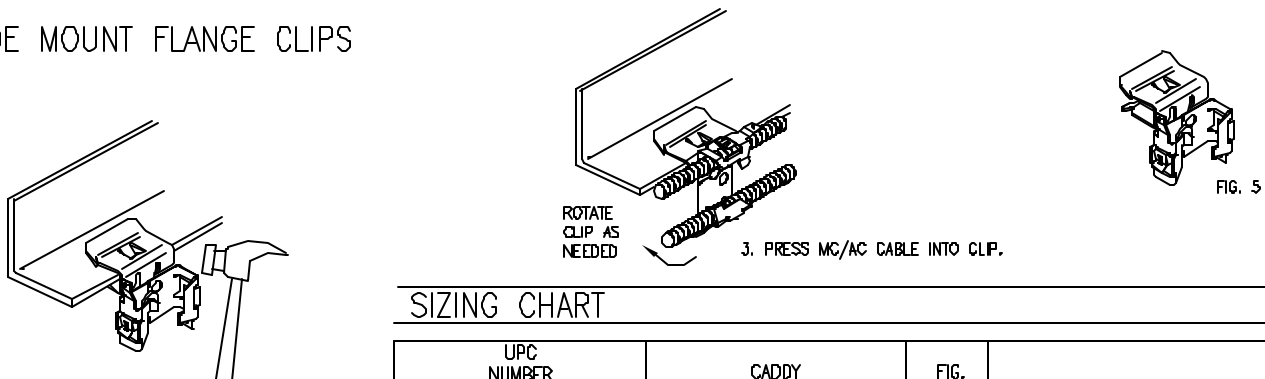

1. WITH HAMMER, TAP CLIP TO FLANGE.
2. TWIST CLIP INTO REQUIRED ORIENTATION.

SIZING CHART

UPC NUMBER 782856-	CADDY PART NUMBER	FIG. NO.	DESCRIPTION
33069	MAC224SM	5	1 OR 2 RUNS OF MC/AC TO 1/8" THRU 1/4" FLANGE
33070	MAC258SM	5	1 OR 2 RUNS OF MC/AC TO 5/16" THRU 1/2" FLANGE
33071	MAC2912SM	5	1 OR 2 RUNS OF MC/AC TO TO 1/2" THRU 3/4" FLANGE

DROP WIRES, RODS AND FLANGES.

1. SQUEEZE FASTENER.
2. CONNECT TOP EDGE OVER WIRE.
3. TWIST INTO PLACE.
4. RELEASE.

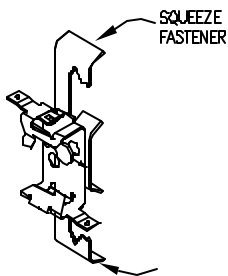

ROTATE INTO PLACE

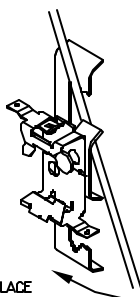

5. PRESS MC/AC CABLE INTO CLIP.

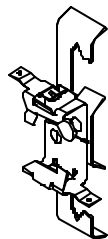
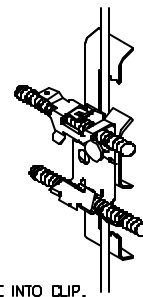

FIG. 10

SIZING CHART

UPC NUMBER 782856-	CADDY PART NUMBER	FIG. NO.	DESCRIPTION
33078	MAC24Z34	10	#12 THRU 1/4" WIRE, PLAIN OR THREADED ROD & 1/8" THRU 3/8" FLANGE FOR 1 OR 2 RUNS MC/AC
33079	MAC26Z34	10	3/8" PLAIN OR THREADED ROD & 3/8" THRU 9/16" FLANGE FOR 1 OR 2 RUNS MC/AC

C & Z PURLIN

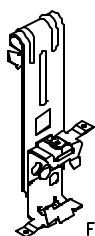
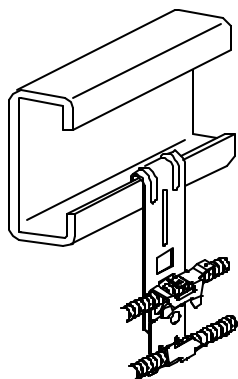

FIG. 6

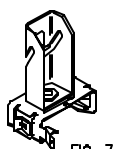
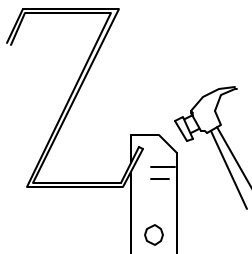
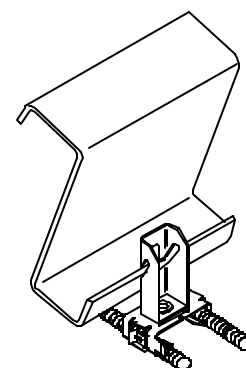

FIG. 7



3. PRESS MC/AC CABLE INTO CLIP.



SIZING CHART

UPC NUMBER 782856-	CADDY PART NUMBER	FIG. NO.	DESCRIPTION
33072	MAC2VF14	6	1 OR 2 RUNS OF MC/AC TO 1/16" THRU 1/4" C PURLIN OR VERTICAL FLANGE
33073	MAC2123	7	1 OR 2 RUNS OF MC/AC CABLE TO Z PURLIN

1. PRESS FASTENER AGAINST FLANGE, TAP STRAIGHT DOWN. (1/16" TO 1/4" FLANGE OR C PURLIN)
2. PRESS MC/AC CABLE INTO CLIP.

WARNING:

CADDY FASTENERS ARE INTENDED FOR INDOOR USE IN NON-CORROSIVE ENVIRONMENTS ONLY. CADDY FASTENERS MUST BE USED ONLY AS ILLUSTRATED. MISUSE OR MISAPPLICATION MAY CAUSE FAILURE RESULTING IN PROPERTY DAMAGE OR BODILY INJURY.

SAFETY INSTRUCTIONS: ALL SAFETY REGULATIONS REQUIRED BY THE JOB SITE MUST BE OBSERVED. SPECIAL ATTENTION SHOULD BE GIVEN TO THE FOLLOWING INSTRUCTIONS:

WHILE WORKING OR ON THE JOB SITE:

1. OBSERVE ALL FEDERAL AND LOCAL SAFETY REGULATIONS.
2. WEAR A HARD HAT.
3. WEAR SAFETY GLASSES WITH SIDE SHIELDS.
4. WEAR GLOVES TO AVOID SPLINTERS AND CUTS.
5. WHEN WORKING ABOVE GROUND LEVEL, BE SURE THE STRUCTURE WILL SUPPORT YOUR WEIGHT.
6. BE AWARE OF PERSONNEL WORKING ABOVE AND BELOW.

ERICO®

© 1999 ERICO, INC.

CFS242C

PRINTED IN U.S.A.



ERICO FASTENING PRODUCTS
34600 SOLON ROAD
SOLON, OH 44139
CUSTOMER SERVICE: (800) 853-0878
FAX: (800) 462-4797
TECHNICAL SUPPORT:
(800) 25-CADDY (252-2339)