

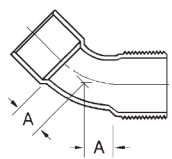

45° ELBOW - MALE

Copper x Male

Cast CP6-4



C x M

Mueller: -- wrot
-- cast
Elkhart: -- wrot
-- cast
Nibco: -- wrot
-- cast

Item No.	Nom. Size (in inches)	Box Qty	Mstr Crtn	Net Wt. Approx.	Dim A	Dim B
CP6-4-08	1/2	25	100	.10	3/16	1
CP6-4-12	3/4	25	25	.18	3/8	1-1/8
CP6-4-16	1	10	10	.39	1/2	1-1/4
CP6-4-20	1-1/4	10	25	.54	1/2	1-1/2

90° ELBOW - (SHORT RADIUS)

Copper x Copper

Cast Wrot CP7-WP7-

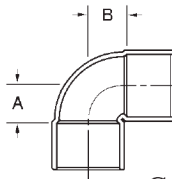

C x C

Mueller: WE-500 wrot
E-200 cast
Elkhart: 107-C wrot
4707 cast
Nibco: 607 wrot
707 cast

Item No.	Nom. Size (in inches)	Box Qty	Mstr Crtn	Net Wt. Approx.	Dim A	Dim B
WP7-02	1/8	50	1000	.01	1/4	1/4
WP7-04	1/4	100	1000	.01	3/8	3/8
WP7-06	3/8	100	1000	.03	21/64	21/64
WP7-08	1/2	100	1000	.05	5/16	5/16
WP7-10	5/8	50	500	.04	17/32	17/32
WP7-12	3/4	50	500	.06	9/16	9/16
WP7-16	1	10	250	.09	5/8	5/8
WP7-20	1-1/4	10	100	.16	7/8	7/8
WP7-24	1-1/2	10	50	.27	1	1
WP7-32	2	10	25	.71	1-1/8	1-1/8
WP7-40	2-1/2	5	25	1.20	1-3/8	1-3/8
WP7-48	3	3	24	1.89	1-61/64	1-61/64
WP7-56	3-1/2	1	8	2.72	2-7/32	2-7/32
WP7-64	4	1	8	4.37	2-17/32	2-17/32
CP7-80	5	—	—	10.49	3-1/18	3-1/18
WP7-80	5	1	1	7.22	3-1/18	3-1/18
CP7-96	6	—	—	17.00	3-13/16	3-13/16
WP7-96	6	1	1	14.86	3-13/16	3-13/16
WP7-99	8	1	1	38.00	5-1/8	5-1/8
WP7-04-02	1/4 X 1/8	100	1000	.01	19/32	15/32
WP7-06-04	3/8 X 1/4	50	1000	.03	41/64	39/64
WP7-08-04	1/2 X 1/4	50	500	.04	11/16	5/8
WP7-08-06	1/2 X 3/8	50	500	.05	7/16	3/8
WP7-10-08	5/8 X 1/2	50	500	.06	31/32	7/8
WP7-12-08	3/4 X 1/2	50	500	.08	11/16	9/16
WP7-16-08	1 X 1/2	25	250	.18	1-1/8	7/8
WP7-16-12	1 X 3/4	25	200	.15	3/4	19/32
CP7-20-08	1 1/4 X 1/2	10	100	.28	2-5/32	1-3/8
CP7-20-12	1 1/4 X 3/4	5	25	.44	5/8	1-1/16
WP7-20-16	1 1/4 X 1	10	100	.24	7/8	1-15/32
CP7-24-08	1 1/2 X 1/2	10	100	.41	—	—
CP7-24-12	1 1/2 X 3/4	5	25	.66	5/8	1
CP7-24-16	1 1/2 X 1	5	25	.75	3/4	13/16
WP7-24-20	1 1/2 X 1 1/4	10	100	.35	1-9/64	55/64
CP7-32-12	2 X 3/4	5	40	.96	—	—
CP7-32-16	2 X 1	5	40	1.07	3/4	1-1/4
CP7-32-20	2 X 1 1/4	5	40	.88	2-1/2	2-1/8
WP7-32-24	2 X 1 1/2	5	40	.60	1-9/16	1-13/64
WP7-40-32	2 1/2 X 2	5	1	1.12	1-7/8	1-1/2
WP7-48-40	3 X 2 1/2	1	8	1.6	2-3/32	1-3/4

45° ELBOW - STREET

Fitting x Copper

Wrot WP6-2

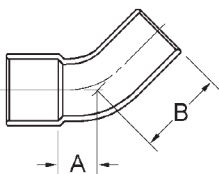

FTG x C

Mueller: WE-505 wrot
-- cast
Elkhart: 106-2 wrot
-- cast
Nibco: 606-2 wrot
706-2 cast

Item No.	Nom. Size (in inches)	Box Qty	Mstr Crtn	Net Wt. Approx.	Dim A	Dim B
WP6-2-04	1/4	50	1000	.01	15/64	41/64
WP6-2-06	3/8	50	1000	.02	9/32	23/32
WP6-2-08	1/2	100	1000	.03	7/16	7/8
WP6-2-10	5/8	25	250	.06	27/64	1-1/16
WP6-2-12	3/4	50	500	.08	5/8	1-1/8
WP6-2-16	1	10	250	.15	3/16	1-1/2
WP6-2-20	1 1/4	10	100	.24	5/8	1-9/16
WP6-2-24	1 1/2	20	100	.31	3/4	1-9/16
WP6-2-32	2	10	50	.64	13/16	2-1/2
WP6-2-40	2 1/2	5	40	.96	29/32	2-7/16
WP6-2-48	3	3	24	1.95	1	2-11/16
WP6-2-64	4	1	8	4.32	1-9/32	3-1/2