

Locking device families

The industry's most complete line of locking industrial devices

Arrow Hart offers the most rugged, feature-rich, broadest line of quality locking devices to meet the specific needs of demanding industrial applications



Hart lock locking devices

The widest range of NEMA and non-NEMA devices, designed and built with superior materials for long lasting performance.



Hart lock 50A locking devices

Rugged pro grip, armored and marine grade 50A locking devices are ideal for harsh construction and industrial applications.



Power lock devices

Power lock devices offer a positive engagement single-post design in rugged nylon or armored shell housings for reliable service.



Hart lock flat cable devices

Hart lock flat cable plugs & connectors are designed specifically for 4-pole, 5-wire flat cable applications in convention and exhibit halls or other high-traffic flat-cable environments.



See Section D for a complete line of watertight, severe-duty and corrosion resistant locking devices.

Hart lock industrial grade 15A locking devices

Product description

2-pole, 3-wire grounding
15A, 125V/AC
NEMA L5-15

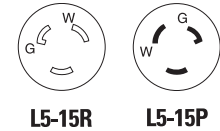

CWL515C

Industrial grade plugs & connectors



Rating A	V/AC	NEMA	Description	Cord diameter	Color	Plug catalog no.	Connector catalog no.		
15	125	L5-15	Safety grip straight body	0.33-0.66" (8.4-16.7mm)	BK & W	<input type="checkbox"/> CWL515P	<input type="checkbox"/> CWL515C	•	•
			Safety grip angled body	0.33-0.66" (8.4-16.7mm)	BK & W	<input type="checkbox"/> CWL515PAN	<input type="checkbox"/> CWL515CAN	•	•
			Auto grip	0.33-0.66" (8.4-16.7mm)	BK & W	<input type="checkbox"/> 4721N	<input type="checkbox"/> 4731N	•	•

Industrial grade receptacles



Rating A	V/AC	NEMA	Description	Color	Single receptacle	Duplex receptacle		
15	125	L5-15	Standard industrial	BK	<input type="checkbox"/> CWL515R*	—	•	•
			Standard industrial	BK	—	<input type="checkbox"/> 4700	•	•
			Isolated ground	RN	<input type="checkbox"/> IGL515R*	<input type="checkbox"/> IG4700*	•	•
		5-15	Combination locking & straight blade	BK	—	<input type="checkbox"/> 5792*	•	•

*Not Fed Spec

Industrial grade flanged inlet



Rating A	V/AC	NEMA	Description	Color	Flanged inlet		
15	125	L5-15	Standard industrial	BK & W	<input type="checkbox"/> CWL515FI	•	•

Industrial grade flanged outlet



Rating A	V/AC	NEMA	Description	Color	Flanged outlet		
15	125	L5-15	Standard industrial	BK & W	<input type="checkbox"/> CWL515FO	•	•

Dimensional information:
C-76-C-78

Plug & connector specification information:

Safety grip K5-15: C-84
Auto grip K5-15: C-84

Receptacle specification information:

K5-15: C-86
Isolated ground K5-15: C-86

Flanged inlet & flanged outlet specification information:
K5-15: C-88

Color information:

BK (Black), RN (Orange), W (White)



Compliances, specifications and availability are subject to change without notice.

Indicates NAFTA compliant - Page Q-30

RoHS compliant - Page Q-30

15A, 20A & 30A locking devices

Safety grip plugs

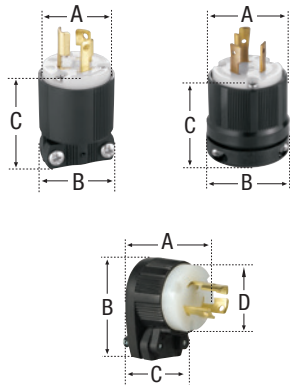

Family	A	B	C	D	Cord diameter
NEMA L2-20	1.37" (34.8mm)	1.50" (38.1mm)	2.06" (52.3mm)	–	0.33-0.66" (8.4-16.7mm)
15A & 10/15A locking	1.37" (34.8mm)	1.50" (38.1mm)	2.06" (52.3mm)	–	0.33-0.66" (8.4-16.7mm)
15A locking angled	1.28" (32.5mm)	1.47" (37.3mm)	1.50" (38.1mm)	2.06" (52.3mm)	0.33-0.66" (8.4-16.7mm)
20/10A locking	2.19" (55.6mm)	2.31" (58.7mm)	2.75" (69.9mm)	–	0.63-1.16" (15.9-29.4mm)
20A locking 2-P, 3-W; 3-P, 3-W	2.00" (50.8mm)	2.12" (53.8mm)	2.34" (59.4mm)	–	0.38-1.00" (9.5-25.4mm)
20A locking 3-P, 4-W; 4-P, 4-W; 4-P, 5-W	2.19" (55.6mm)	2.31" (58.7mm)	2.75" (69.9mm)	–	0.63-1.16" (15.9-29.4mm)
30A locking 2-P, 3-W; 3-P, 3-W	2.00" (50.8mm)	2.12" (53.8mm)	2.34" (59.4mm)	–	0.38-1.00" (9.5-25.4mm)
30A locking 3-P, 4-W; 4-P, 4-W; 4-P, 5-W	2.19" (55.6mm)	2.31" (58.7mm)	2.75" (69.9mm)	–	0.63-1.16" (15.9-29.4mm)

Safety grip connectors

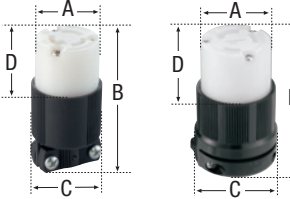

Family	A	B	C	D	Cord diameter
NEMA L2-20	1.37" (34.8mm)	2.88" (73.0mm)	1.50" (38.1mm)	1.00" (25.4mm)	0.33-0.66" (8.4-16.7mm)
15A & 10/15A locking	1.37" (34.8mm)	2.88" (73.0mm)	1.50" (38.1mm)	1.00" (25.4mm)	0.33-0.66" (8.4-16.7mm)
20/10A locking	1.37" (34.8mm)	2.88" (73.0mm)	1.50" (38.1mm)	1.00" (25.4mm)	0.33-0.66" (8.4-16.7mm)
20A locking 2-P, 3-W; 3-P, 3-W	2.00" (50.8mm)	3.44" (87.3mm)	2.12" (53.8mm)	1.31" (33.3mm)	0.38-1.00" (9.5-25.4mm)
20A locking 3-P, 4-W	2.00" (50.8mm)	3.44" (87.3mm)	2.12" (53.8mm)	1.31" (33.3mm)	0.38-1.00" (9.5-25.4mm)
20A locking 4-P, 4-W & 4-P, 5-W	2.19" (55.6mm)	3.75" (95.3mm)	2.31" (58.7mm)	1.22" (31.0mm)	0.63-1.16" (15.9-29.4mm)
30A locking 2-P, 3-W; 3-P, 3-W	2.00" (50.8mm)	3.44" (87.3mm)	2.12" (53.8mm)	1.31" (33.3mm)	0.38-1.00" (9.5-25.4mm)
30A locking 3-P, 4-W; 4-P, 4-W; 4-P, 5-W	2.19" (55.6mm)	3.75" (95.3mm)	2.31" (58.7mm)	1.22" (31.0mm)	0.63-1.16" (15.9-29.4mm)

Auto grip plugs

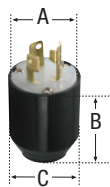

Family	A	B	C	Cord dia.
15A & 10/15A locking	1.38" (34.9mm)	1.83" (46.5mm)	1.52" (38.6mm)	0.33-0.66" (8.4-16.7mm)

Auto grip connectors



Family	A	B	C	Cord dia.
15A & 10/15A locking	1.38" (34.9mm)	1.83" (46.5mm)	1.52" (38.6mm)	0.33-0.66" (8.4-16.7mm)

Ultra grip locking plugs & connectors

Family	A	B	C	D	Cord diameter
Ultra grip plug, 2P-3W, 3P-3W	1.78" (45.2mm)	2.59" (65.8mm)	2.23" (56.6mm)	2.10" (53.3mm)	0.38-1.00" (9.6 - 25.4mm)
Ultra grip plug, 3P-4W, 4P-4W, 4P-5W	2.18" (55.4mm)	2.82" (71.6mm)	2.13" (54.1mm)	2.30" (58.4mm)	0.38-1.16" (9.6 - 29.5mm)
Ultra grip connector, 2P-3W, 3P-3W	1.78" (45.2mm)	3.61" (91.7mm)	2.23" (56.6mm)	2.10" (53.3mm)	0.38-1.00" (9.6 - 25.4mm)
Ultra grip connector, 3P-4W, 4P-4W, 4P-5W	1.97" (50.0mm)	3.84" (97.5mm)	2.46" (62.5mm)	2.30" (58.4mm)	0.38-1.16" (9.6 - 29.5mm)

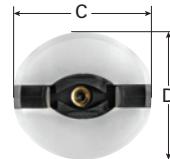
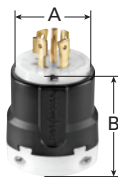

Compliances, specifications and availability are subject to change without notice.

Locking devices specification & performance data

Industrial grade 15A, 20A & 30A locking plugs & connectors

Product description

2-pole, 3-wire grounding; 3-pole, 3-wire non-grounding;
3-pole, 4-wire grounding; 4-pole, 4-wire non-grounding;
4-pole, 5-wire grounding

20A & 30A ultra grip plugs & connectors: L6-20, L7-20, L8-20, L6-30, L7-30, L10-20, L14-20, L15-20, L16-20, L14-30, L15-30, L16-30, L17-30, L19-20, L20-20, L19-30, L20-30, L23-20, L23-30, Non-NEMA 20A, Non-NEMA 30A, Non-NEMA 20/10A

Device type	15A safety grip & auto grip plugs & connectors: NEMA L5-15, L6-15, L7-15	15A safety grip & auto grip plugs & connectors: Non-NEMA 10/15A	20A & 30A ultra grip plugs & connectors: L6-20, L7-20, L8-20, L6-30, L7-30, L10-20, L14-20, L15-20, L16-20, L14-30, L15-30, L16-30, L17-30, L19-20, L20-20, L19-30, L20-30, L23-20, L23-30, Non-NEMA 20A, Non-NEMA 30A, Non-NEMA 20/10A
Wiring type	Side wire	Back wire	Back wire
Testing & code compliance	<ul style="list-style-type: none"> cULus Listed to UL498, file no. E3663 UL verified to Fed Spec WC-596F cUL Listed to CSA C22.2, no. 42 file no. E3663 	<ul style="list-style-type: none"> UL recognized component for US & Canada, file no. E3663 	<ul style="list-style-type: none"> cULus Listed to UL498, file no. E3663
Environmental specifications	<p>Flammability: Meets UL94 requirements, V0 rated</p> <p>Temperature rating: -40°C to 60°C (-40°F to 140°F)</p>	<p>Flammability: Meets UL94 requirements, V2 rated</p> <p>Temperature rating: -40°C to 60°C (-40°F to 140°F)</p>	<p>Flammability: Meets UL94 requirements, V2 rated</p> <p>Temperature rating: -40°C to 60°C (-40°F to 140°F)</p>
Electrical specifications	<p>Dielectric voltage: Twice the device rating + 1000V per UL498</p> <p>Current interrupting: Yes, at full-rated current</p> <p>Temperature rise: Max. 30°C (86°F) after 200 cycles of overload</p>	<p>Dielectric voltage: Twice the device rating + 1000V per UL498</p> <p>Current interrupting: Yes, at full-rated current</p> <p>Temperature rise: Max. 30°C (86°F) after 200 cycles of overload</p>	<p>Dielectric voltage: Twice the device rating + 1000V per UL498</p> <p>Current interrupting: Yes, at full-rated current</p> <p>Temperature rise: Max. 30°C (86°F) after 200 cycles of overload</p>
Mechanical specifications	<p>Terminal accommodation: #16 - #12 AWG</p> <p>Voltage ratings: Permanently marked on device</p>	<p>Terminal accommodation: #16 - #12 AWG</p> <p>Voltage ratings: Permanently marked on device</p>	<p>Terminal accommodation: #16 - #12 AWG, except isolated ground: #14 - #8 AWG</p> <p>Voltage ratings: Permanently marked on device</p>
Materials	<p>Outer shell: Safety grip: nylon; auto grip: phenolic</p> <p>Interior body: Safety grip: nylon; auto grip: phenolic</p> <p>Terminal retainer: Polycarbonate</p> <p>Blades: Brass</p> <p>Line contacts: Brass</p> <p>Terminal clamps: Steel, zinc-plated</p> <p>Terminal screws: Brass</p> <p>Ground screw: Brass</p> <p>Assembly screws: Steel, zinc-plated</p> <p>Gasket/dust shield: Neoprene</p> <p>Cord clamp screws: Steel, zinc-plated</p> <p>Cord clamp: Steel, zinc-plated</p>	<p>Outer shell: Nylon</p> <p>Interior body: Nylon</p> <p>Terminal retainer: Polycarbonate</p> <p>Blades: Brass</p> <p>Line contacts: Brass</p> <p>Terminal clamps: Steel, zinc-plated</p> <p>Terminal screws: Brass</p> <p>Ground screw: Brass</p> <p>Assembly screws: Steel, zinc-plated</p> <p>Gasket/dust shield: Neoprene</p> <p>Cord clamp screws: Steel, zinc-plated</p> <p>Cord clamp: Steel, zinc-plated</p>	<p>Outer shell: Nylon</p> <p>Interior body: Nylon</p> <p>Terminal retainer: Polycarbonate</p> <p>Blades: Brass</p> <p>Line contacts: Connectors: zinc plated</p> <p>Terminal clamps: Steel</p> <p>Terminal screws: #10-32 brass, neutral screw nickel plated</p> <p>Ground screw: #10-32 brass (green)</p> <p>Assembly screws: Steel, zinc-plated</p> <p>Gasket/dust shield: Neoprene</p> <p>Cord clamp screws: Steel, zinc-plated</p> <p>Cord clamp: Nylon</p>

Compliances, specifications and availability are subject to change without notice.

Industrial Specification Grade Hart-Lock® Locking Devices

2 Pole, 3 Wire Grounding
3 Pole, 3 Wire Non-Grounding
NEMA L5-15, 15A 125V
NEMA L6-15, 15A 250V
NEMA L7-15, 15A 277V
Non-NEMA 15/10A 125/250V



INDUSTRIAL
COMMERCIAL

E-6
LOCKING
DEVICES

15A 3 Wire Industrial Specification Grade Plugs and Connectors

FEATURES

- Nylon construction.
- Back wire Dead-Front design.
- Neoprene gasket seals cord hole from dust and debris.
- Dual range cord grip provides solid cord clamp.
- Back wire terminal clamps for easy secure wiring.
- Individual wiring compartments with tapered channel for easy insertion of wires.
- Clear cover over wiring compartments allow easy inspection of wiring terminations.
- Combination head screws standard - slot/Phillips in the U.S.
- Add "-C" to catalog number for Canadian screws - slot/Robertson head combination.

Safety Grip™ Industrial Specification Grade Locking Plugs and Connectors

Rating A	V/AC	NEMA	Config- uration	Description/ Cord Diameter	Color	Catalog No.	
						Plug	Connector
15	125	L5-15	2 Pole, 3 Wire	Straight: 0.250"-0.656" (6.4mm-16.7mm)	Black & White	CWL515P	CWL515C
				Straight: 0.250"-0.656" (6.4mm-16.7mm)	Black	4721BK	4731BK
				Angle: 0.300"-0.656" (7.62mm-16.7mm)	Black & White	CWL515PAN	CWL515CAN
15	250	L6-15	2 Pole, 3 Wire	Straight: 0.250"-0.656" (6.4mm-16.7mm)	Black & White	CWL615P	CWL615C
				Angle: 0.300"-0.656" (7.62mm-16.7mm)	Black & White	CWL615PAN	—
15	277	L7-15	2 Pole, 3 Wire	Straight: 0.250"-0.656" (6.4mm-16.7mm)	Black & White	CWL715P	CWL715C
				Angle: 0.300"-0.656" (7.62mm-16.7mm)	Black & White	CWL715PAN	—
15/ 10	125/ 250	Non- NEMA	3 Pole, 3 Wire	Straight: 0.250"-0.656" (6.4mm-16.7mm)	Black & White	4767*	4755*
				Angle: 0.300"-0.656" (7.62mm-16.7mm)	Black & White	4767AN*	—

*Not CSA certified

NOTE: Weather Protective Boots from Cooper Wiring Devices that may be used with these products are described on page E-72 in this section.

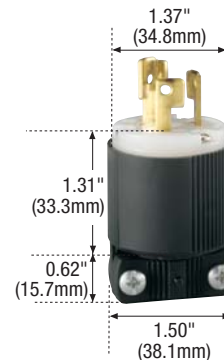

CWL515P



CWL515C

TESTING & CODE COMPLIANCE

- Listed to UL 498, (file no. E3663).
- CSA Certified to C22.2 no. 42 (file no. LR7087) except as noted.

MATERIAL CHARACTERISTICS

Nylon.
Temperature Rating:
-40°C to 75°C.

