

Locking device families

The industry's most complete line of locking industrial devices

Arrow Hart offers the most rugged, feature-rich, broadest line of quality locking devices to meet the specific needs of demanding industrial applications



Hart lock locking devices

The widest range of NEMA and non-NEMA devices, designed and built with superior materials for long lasting performance.



Hart lock 50A locking devices

Rugged pro grip, armored and marine grade 50A locking devices are ideal for harsh construction and industrial applications.



Power lock devices

Power lock devices offer a positive engagement single-post design in rugged nylon or armored shell housings for reliable service.



Hart lock flat cable devices

Hart lock flat cable plugs & connectors are designed specifically for 4-pole, 5-wire flat cable applications in convention and exhibit halls or other high-traffic flat-cable environments.



See Section D for a complete line of watertight, severe-duty and corrosion resistant locking devices.

Hart lock industrial grade 20A locking devices

Product description

2-pole, 3-wire grounding
20A, 125V/AC
NEMA L5-20



L5-20R

L5-20P



AHL520C

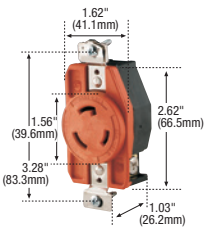

IGL520R



AHL520FO

Industrial grade plugs & connectors



Rating	V/AC	NEMA	Description	Cord diameter	Color	Plug catalog no.	Connector catalog no.	
20	125	L5-20	Ultra grip straight body	0.38-1.16" (9.5-29.4mm)	BK & W	<input type="checkbox"/> AHL520P	<input type="checkbox"/> AHL520C	
			Safety grip straight body	0.38-1.00" (9.5-25.4mm)	BK	<input type="checkbox"/> CWL520PBK	<input type="checkbox"/> CWL520CBK	

Industrial grade receptacles



Rating	V/AC	NEMA	Description	Color	Single receptacle	
20	125	L5-20	Standard industrial	BK	<input type="checkbox"/> AHL520R	
			Isolated ground	RN	<input type="checkbox"/> IGL520R*	

*Not Fed Spec

Industrial grade flanged inlets & outlets



Rating	V/AC	NEMA	Description	Color	Flanged inlet	Flanged outlet	
20	125	L5-20	Standard industrial	BK & W	<input type="checkbox"/> AHL520FI	<input type="checkbox"/> AHL520FO ^{††}	

^{††}Only UL Listed

Accessories for NEMA L5-20 locking devices

Description	Catalog no.	
Neoprene weather protective boot for 20/30A, 3-W locking plug	<input type="checkbox"/> BM1	
Neoprene weather protective boot for 20/30A, 3-W locking connector	<input type="checkbox"/> BM2	
Diecast aluminum single receptacle cover, vertical mount, for FS/FD boxes	<input type="checkbox"/> 7420	



BM1



BM2



7420

Dimensional information:

C-76-C-78

Plug & connector specification information:

Ultra grip K5-20: C-84

Receptacle specification information:

K5-20: C-87
Isolated ground K5-20: C-87

Flanged inlet & flanged outlet specification information:

K5-20: C-88

Color information:

BK (Black), RN (Orange), W (White)



Compliances, specifications and availability are subject to change without notice.



Indicates NAFTA compliant - Page Q-30



RoHS compliant - Page Q-30

15A, 20A & 30A locking devices

Safety grip plugs

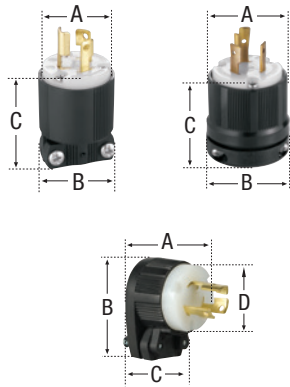

Family	A	B	C	D	Cord diameter
NEMA L2-20	1.37" (34.8mm)	1.50" (38.1mm)	2.06" (52.3mm)	–	0.33-0.66" (8.4-16.7mm)
15A & 10/15A locking	1.37" (34.8mm)	1.50" (38.1mm)	2.06" (52.3mm)	–	0.33-0.66" (8.4-16.7mm)
15A locking angled	1.28" (32.5mm)	1.47" (37.3mm)	1.50" (38.1mm)	2.06" (52.3mm)	0.33-0.66" (8.4-16.7mm)
20/10A locking	2.19" (55.6mm)	2.31" (58.7mm)	2.75" (69.9mm)	–	0.63-1.16" (15.9-29.4mm)
20A locking 2-P, 3-W; 3-P, 3-W	2.00" (50.8mm)	2.12" (53.8mm)	2.34" (59.4mm)	–	0.38-1.00" (9.5-25.4mm)
20A locking 3-P, 4-W; 4-P, 4-W; 4-P, 5-W	2.19" (55.6mm)	2.31" (58.7mm)	2.75" (69.9mm)	–	0.63-1.16" (15.9-29.4mm)
30A locking 2-P, 3-W; 3-P, 3-W	2.00" (50.8mm)	2.12" (53.8mm)	2.34" (59.4mm)	–	0.38-1.00" (9.5-25.4mm)
30A locking 3-P, 4-W; 4-P, 4-W; 4-P, 5-W	2.19" (55.6mm)	2.31" (58.7mm)	2.75" (69.9mm)	–	0.63-1.16" (15.9-29.4mm)

Safety grip connectors

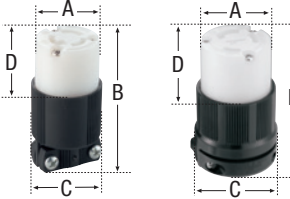

Family	A	B	C	D	Cord diameter
NEMA L2-20	1.37" (34.8mm)	2.88" (73.0mm)	1.50" (38.1mm)	1.00" (25.4mm)	0.33-0.66" (8.4-16.7mm)
15A & 10/15A locking	1.37" (34.8mm)	2.88" (73.0mm)	1.50" (38.1mm)	1.00" (25.4mm)	0.33-0.66" (8.4-16.7mm)
20/10A locking	1.37" (34.8mm)	2.88" (73.0mm)	1.50" (38.1mm)	1.00" (25.4mm)	0.33-0.66" (8.4-16.7mm)
20A locking 2-P, 3-W; 3-P, 3-W	2.00" (50.8mm)	3.44" (87.3mm)	2.12" (53.8mm)	1.31" (33.3mm)	0.38-1.00" (9.5-25.4mm)
20A locking 3-P, 4-W	2.00" (50.8mm)	3.44" (87.3mm)	2.12" (53.8mm)	1.31" (33.3mm)	0.38-1.00" (9.5-25.4mm)
20A locking 4-P, 4-W & 4-P, 5-W	2.19" (55.6mm)	3.75" (95.3mm)	2.31" (58.7mm)	1.22" (31.0mm)	0.63-1.16" (15.9-29.4mm)
30A locking 2-P, 3-W; 3-P, 3-W	2.00" (50.8mm)	3.44" (87.3mm)	2.12" (53.8mm)	1.31" (33.3mm)	0.38-1.00" (9.5-25.4mm)
30A locking 3-P, 4-W; 4-P, 4-W; 4-P, 5-W	2.19" (55.6mm)	3.75" (95.3mm)	2.31" (58.7mm)	1.22" (31.0mm)	0.63-1.16" (15.9-29.4mm)

Auto grip plugs

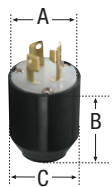

Family	A	B	C	Cord dia.
15A & 10/15A locking	1.38" (34.9mm)	1.83" (46.5mm)	1.52" (38.6mm)	0.33-0.66" (8.4-16.7mm)

Auto grip connectors



Family	A	B	C	Cord dia.
15A & 10/15A locking	1.38" (34.9mm)	1.83" (46.5mm)	1.52" (38.6mm)	0.33-0.66" (8.4-16.7mm)

Ultra grip locking plugs & connectors

Family	A	B	C	D	Cord diameter
Ultra grip plug, 2P-3W, 3P-3W	1.78" (45.2mm)	2.59" (65.8mm)	2.23" (56.6mm)	2.10" (53.3mm)	0.38-1.00" (9.6 - 25.4mm)
Ultra grip plug, 3P-4W, 4P-4W, 4P-5W	2.18" (55.4mm)	2.82" (71.6mm)	2.13" (54.1mm)	2.30" (58.4mm)	0.38-1.16" (9.6 - 29.5mm)
Ultra grip connector, 2P-3W, 3P-3W	1.78" (45.2mm)	3.61" (91.7mm)	2.23" (56.6mm)	2.10" (53.3mm)	0.38-1.00" (9.6 - 25.4mm)
Ultra grip connector, 3P-4W, 4P-4W, 4P-5W	1.97" (50.0mm)	3.84" (97.5mm)	2.46" (62.5mm)	2.30" (58.4mm)	0.38-1.16" (9.6 - 29.5mm)

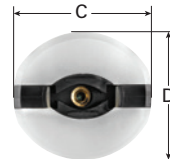
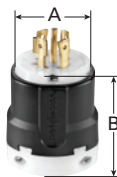

Compliances, specifications and availability are subject to change without notice.

Locking devices specification & performance data

Industrial grade 15A, 20A & 30A locking plugs & connectors

Product description

2-pole, 3-wire grounding; 3-pole, 3-wire non-grounding;
3-pole, 4-wire grounding; 4-pole, 4-wire non-grounding;
4-pole, 5-wire grounding

20A & 30A ultra grip plugs & connectors: L6-20, L7-20, L8-20, L6-30, L7-30, L10-20, L14-20, L15-20, L16-20, L14-30, L15-30, L16-30, L17-30, L19-20, L20-20, L19-30, L20-30, L23-20, L23-30, Non-NEMA 20A, Non-NEMA 30A, Non-NEMA 20/10A

Device type	15A safety grip & auto grip plugs & connectors: NEMA L5-15, L6-15, L7-15	15A safety grip & auto grip plugs & connectors: Non-NEMA 10/15A	20A & 30A ultra grip plugs & connectors: L6-20, L7-20, L8-20, L6-30, L7-30, L10-20, L14-20, L15-20, L16-20, L14-30, L15-30, L16-30, L17-30, L19-20, L20-20, L19-30, L20-30, L23-20, L23-30, Non-NEMA 20A, Non-NEMA 30A, Non-NEMA 20/10A
Wiring type	Side wire	Back wire	Back wire
Testing & code compliance	<ul style="list-style-type: none"> cULus Listed to UL498, file no. E3663 UL verified to Fed Spec WC-596F cUL Listed to CSA C22.2, no. 42 file no. E3663 	<ul style="list-style-type: none"> UL recognized component for US & Canada, file no. E3663 	<ul style="list-style-type: none"> cULus Listed to UL498, file no. E3663
Environmental specifications	<p>Flammability: Meets UL94 requirements, V0 rated</p> <p>Temperature rating: -40°C to 60°C (-40°F to 140°F)</p>	<p>Flammability: Meets UL94 requirements, V2 rated</p> <p>Temperature rating: -40°C to 60°C (-40°F to 140°F)</p>	<p>Flammability: Meets UL94 requirements, V2 rated</p> <p>Temperature rating: -40°C to 60°C (-40°F to 140°F)</p>
Electrical specifications	<p>Dielectric voltage: Twice the device rating + 1000V per UL498</p> <p>Current interrupting: Yes, at full-rated current</p> <p>Temperature rise: Max. 30°C (86°F) after 200 cycles of overload</p>	<p>Dielectric voltage: Twice the device rating + 1000V per UL498</p> <p>Current interrupting: Yes, at full-rated current</p> <p>Temperature rise: Max. 30°C (86°F) after 200 cycles of overload</p>	<p>Dielectric voltage: Twice the device rating + 1000V per UL498</p> <p>Current interrupting: Yes, at full-rated current</p> <p>Temperature rise: Max. 30°C (86°F) after 200 cycles of overload</p>
Mechanical specifications	<p>Terminal accommodation: #16 - #12 AWG</p> <p>Voltage ratings: Permanently marked on device</p>	<p>Terminal accommodation: #16 - #12 AWG</p> <p>Voltage ratings: Permanently marked on device</p>	<p>Terminal accommodation: #16 - #12 AWG, except isolated ground: #14 - #8 AWG</p> <p>Voltage ratings: Permanently marked on device</p>
Materials	<p>Outer shell: Safety grip: nylon; auto grip: phenolic</p> <p>Interior body: Safety grip: nylon; auto grip: phenolic</p> <p>Terminal retainer: Polycarbonate</p> <p>Blades: Brass</p> <p>Line contacts: Brass</p> <p>Terminal clamps: Steel, zinc-plated</p> <p>Terminal screws: Brass</p> <p>Ground screw: Brass</p> <p>Assembly screws: Steel, zinc-plated</p> <p>Gasket/dust shield: Neoprene</p> <p>Cord clamp screws: Steel, zinc-plated</p> <p>Cord clamp: Steel, zinc-plated</p>	<p>Outer shell: Nylon</p> <p>Interior body: Nylon</p> <p>Terminal retainer: Polycarbonate</p> <p>Blades: Brass</p> <p>Line contacts: Brass</p> <p>Terminal clamps: Steel, zinc-plated</p> <p>Terminal screws: Brass</p> <p>Ground screw: Brass</p> <p>Assembly screws: Steel, zinc-plated</p> <p>Gasket/dust shield: Neoprene</p> <p>Cord clamp screws: Steel, zinc-plated</p> <p>Cord clamp: Steel, zinc-plated</p>	<p>Outer shell: Nylon</p> <p>Interior body: Nylon</p> <p>Terminal retainer: Polycarbonate</p> <p>Blades: Brass</p> <p>Line contacts: Connectors: zinc plated</p> <p>Terminal clamps: Steel</p> <p>Terminal screws: #10-32 brass, neutral screw nickel plated</p> <p>Ground screw: #10-32 brass (green)</p> <p>Assembly screws: Steel, zinc-plated</p> <p>Gasket/dust shield: Neoprene</p> <p>Cord clamp screws: Steel, zinc-plated</p> <p>Cord clamp: Nylon</p>

Compliances, specifications and availability are subject to change without notice.

Industrial Specification Grade Hart-Lock® Locking Devices

2 Pole, 3 Wire Grounding
NEMA L5-20, 20A 125V
NEMA L6-20, 20A 250V
NEMA L7-20, 20A 277V
NEMA L8-20, 20A 480V
NEMA L9-20, 20A 600V

20A 2 Pole, 3 Wire Grounding Industrial Specification Grade Plugs and Connectors

FEATURES

- All nylon construction.
- Back wire Dead-Front design.
- Neoprene gasket seals cord hole from dust and debris.
- Inserts included for three separate cord grip ranges.
- Back wire terminal clamps for easy secure wiring.
- Individual wiring compartments with tapered channel for easy insertion of wires.
- Clear cover over wiring compartments allow easy inspection of wiring terminations.
- Combination head screws standard - slot/Phillips in the U.S.
- Add "-C" to catalog number for Canadian screws - slot/Robertson head combination.

Industrial Specification Grade Locking Plugs and Connectors

Rating A	V/AC	NEMA	Description/ Cord Diameter	Color	Catalog No. Plug	Connector
15	125	L5-20	Straight: 0.38"-1.00" (9.5mm-25.4mm)	Black & White	CWL520P	CWL520C
			Straight: 0.38"-1.00" (9.5mm-25.4mm)	Black	CWL520PBK	CWL520CBK
			Corrosion Resistant: 0.38"-1.00" (9.5mm-25.4mm)	Yellow	CRL520P	CRL520C
			Isolated Ground: 0.38"-1.00" (9.5mm-25.4mm)	Orange	IGL520P	—
20	250	L6-20	Straight: 0.38"-1.00" (9.5mm-25.4mm)	Black & White	CWL620P	CWL620C
			Straight: 0.38"-1.00" (9.5mm-25.4mm)	Black	6212BK	6214BK
			Corrosion Resistant: 0.38"-1.00" (9.5mm-25.4mm)	Yellow	CRL620P	—
			Isolated Ground: 0.38"-1.00" (9.5mm-25.4mm)	Orange	IGL620P	—
20	277	L7-20	Straight: 0.38"-1.00" (9.5mm-25.4mm)	Black & White	CWL720P	CWL720C
20	480	L8-20	Straight: 0.38"-1.00" (9.5mm-25.4mm)	Black & White	CWL820P	CWL820C
20	600	L9-20	Straight: 0.30"-0.95" (7.6mm-24.1mm)	Black & White	CWL920P**	CWL920C**

** UL (file no E1381), CSA (file no. LR16215)

NOTE: Weather Protective Boots from Cooper Wiring Devices that may be used with these products are described on page E-72 in this section.

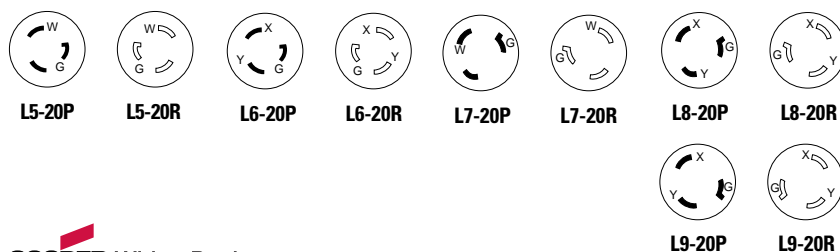

CWL520C



CWL520P

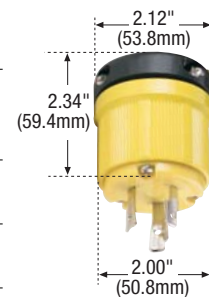

CRL520P



CWL620P



CRL520C



INDUSTRIAL
COMMERCIAL

E-10
LOCKING
DEVICES

TESTING & CODE COMPLIANCE

- Listed to UL 498 (file no. E3663).
- cUL Certified to CSA C22.2 no. 42. (file no. E3663).

MATERIAL CHARACTERISTICS

Nylon.
Temperature Rating:
-40°C to 75°C;
except CWL920P,
CWL920C,
-40°C to 60°C.