

# Central Brass®

The Easy Choice

2950 East 55<sup>th</sup> St. Cleveland, Ohio 44127

Phone: (216) 883-0220 Fax: (216) 883-0875

www.CentralBrass.com

MODEL NOS. 0950 0958 0968 80968

**Three-Valve Bath & Shower Fitting**

I.P. Unions 8-inch Centers

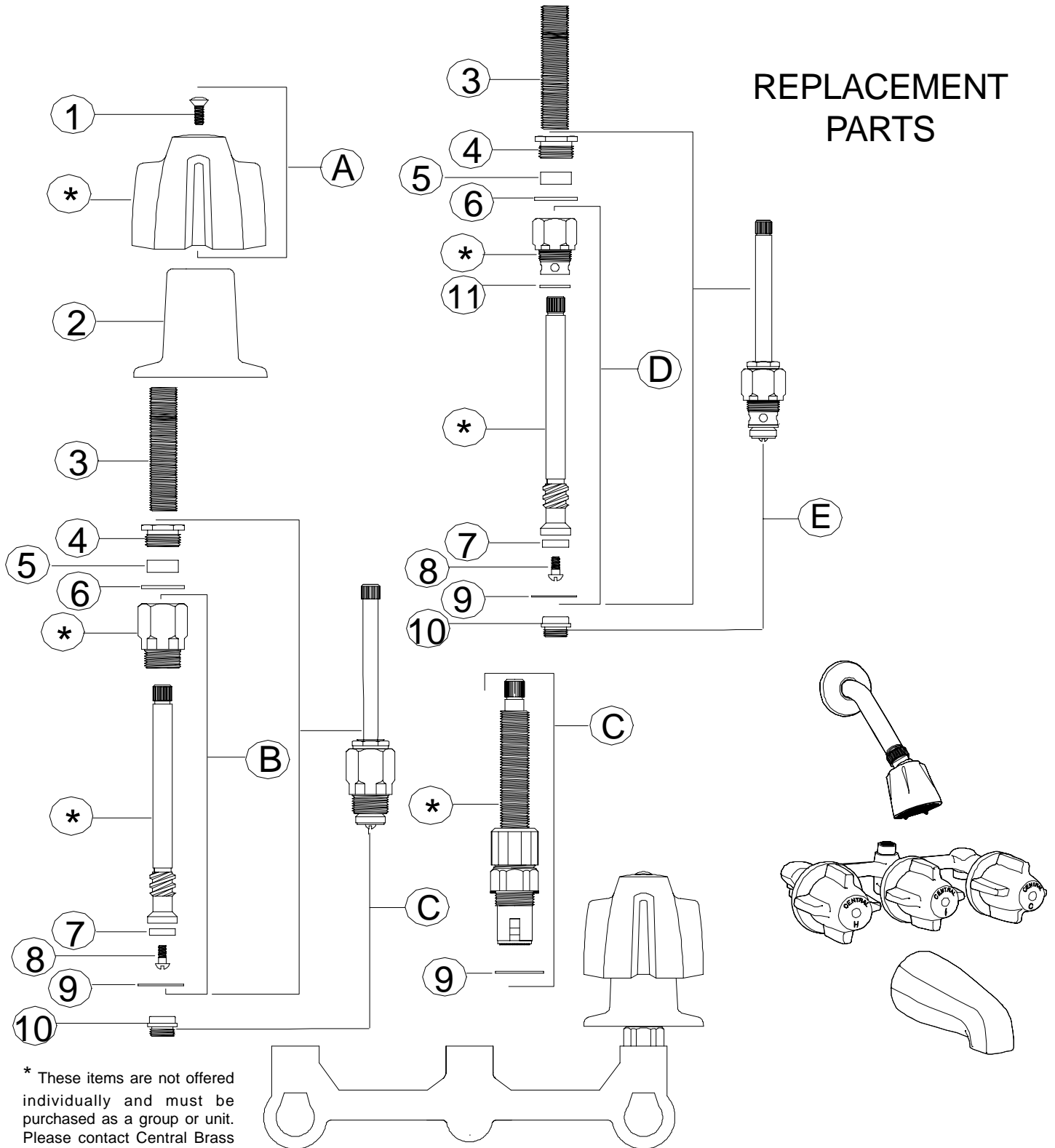

\* These items are not offered individually and must be purchased as a group or unit. Please contact Central Brass for more information.

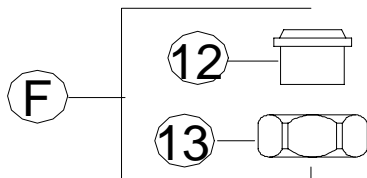

*Heart of Brass*  
Quality Castings Made in USA

## Parts for Integral Stops

For items with **I** suffix only

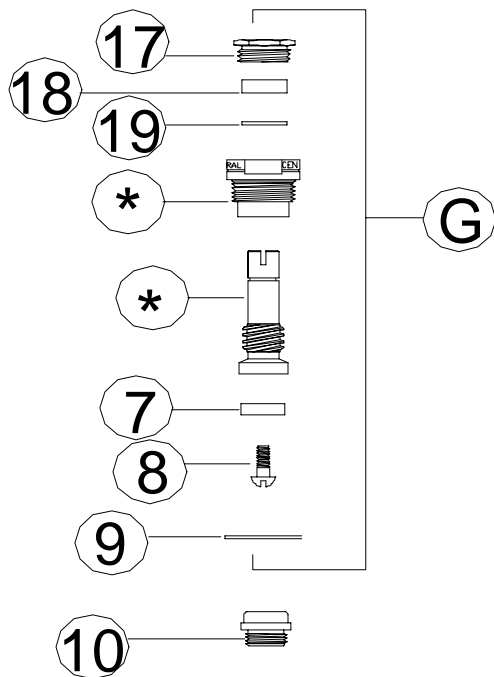
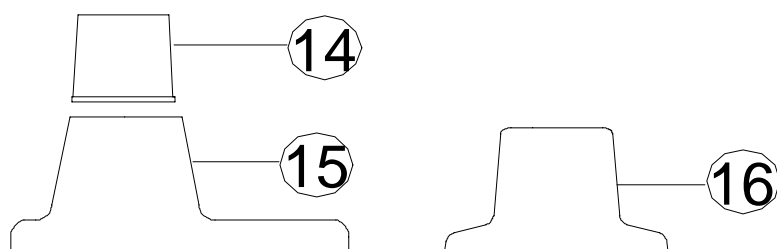

# Central Brass®

The Easy Choice

2950 East 55<sup>th</sup> St. Cleveland, Ohio 44127

Phone:(216)883-0220 Fax: (216)883-0875

www.CentralBrass.com

MODEL NOS. 0950 0958 0968 80968

**Three-Valve Bath & Shower Fitting**

**I.P. Unions 8-inch Centers**

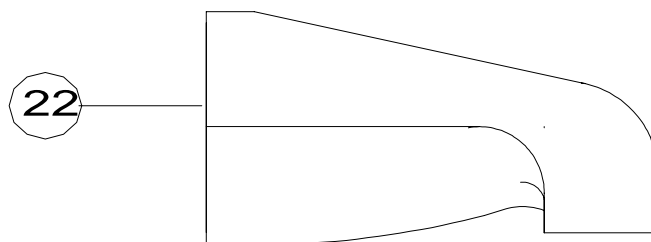
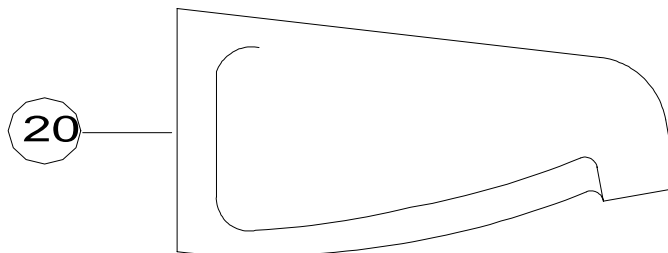
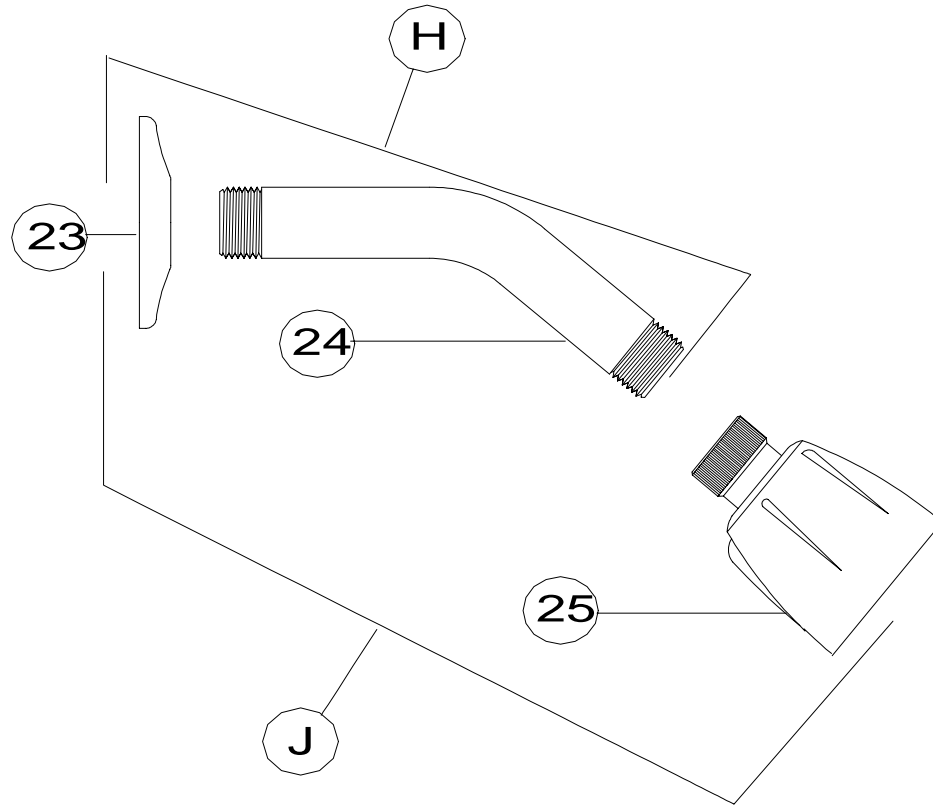

## REPLACEMENT PARTS

| #  | Part #      | Description  |
|----|-------------|--|
| A  | G-508-C     | Large Canopy Handle indexed C with Screw (X107-F)  |
| A  | G-508-H     | Large Canopy Handle indexed H with Screw (X107-F)  |
| A  | G-508-D     | Large Canopy Handle indexed with Arrow for Diverter with Screw (X107-F)  |
| B  | G-1549-CT   | Corner Stem & Bonnet Group with Seat Washer (X901-WN), Screw (X104) & Gasket (1028-Y) for 0950, 0958 & 0968 only |
| C  | K-3-CT      | Complete Corner Stem Assembly with Gasket (X1028-Y) & Bronze Seat (X263-BC) for 0950, 0958 & 0968 only           |
| C  | K-351-C     | Ceramic-disc Stem Cartridge Cold with Gasket (X1028-Y) for item 80968 only                                       |
| D  | G-1588-CT   | Diverter Stem & Bonnet Group with Seat Washer (X901-WN) & Screw (X104)   |
| E  | K-3-DT      | Complete Diverter Stem Assembly With Gasket (X1028-Y) & Bronze Seat (X263-BC)                                    |
| F  | G-30        | IP Union Sleeve (X1875) & Nut (X1876-BB)   |
| G  | XSU-353-ERS | Ceramic-disc Stem Cartridge Hot with Gasket (X1028-Y) for item 80997 only  |
| H  | 3007-6      | 6-inch Shower Arm (714-WT-02) & Flange (X1035-SS)  |
| J  | G-3113-6    | Shower Head (3034-1/2-02), 6-inch Shower Arm (714-WT-02) & Flange (X1035-SS)                                     |
| 1  | X107-F      | Handle Screw (25 pcs per pack)   |
| 2  | 521-B       | Escutcheon   |
| 3  | X269-29/16  | 2 <sup>9</sup> / <sub>16</sub> Long Nipple (10 pcs per pack)   |
| 4  | X765-TA     | Packing Nut (6 pcs per pack)   |
| 5  | X814-BA     | Packing (10 pcs per pack)  |
| 6  | X4-L        | Packing Washer (6 pcs per pack)  |
| 7  | X901-WNN    | Seat Washer (25 pcs per pack)  |
| 8  | X104        | Seat Washer Screw (25 pcs per pack)  |
| 9  | X1028-Y     | Gasket (25 pcs per pack)   |
| 10 | XPF-263-B   | Replacement Seat (4 pcs per pack)  |
| 11 | X4-N        | Celcon Washer for diverter stem (6 pcs per pack)   |
| 12 | X1875       | IP Union Sleeve (2 pcs per pack)   |
| 13 | X1876-BB    | Coupling Nut (2 pcs per pack)  |
| 14 | 1037-ES     | Escutcheon Sleeve for I suffix Integral Valve only   |
| 15 | 1037-ET     | Teardrop Escutcheon for I suffix Integral Valve only   |
| 16 | 1037-ER     | Diverter Escutcheon for I suffix Integral Valve only   |
| 17 | X353-DH     | Packing Nut (10 pcs per pack) for I suffix Integral Valve only   |
| 18 | X353-CW     | Packing (10 pcs per pack) for I suffix Integral Valve only   |
| 19 | X193-B      | Brass Washer (6 pcs per pack) for I suffix Integral Valve only   |
| 20 | 3145-D      | ½ IPS Brass Spout for item 0958, 0968 & 80968 only   |
| 22 | 3154-Z      | Zamak Spout for item 0958-Z, 0968-Z & 80968-Z only   |
| 23 | X1035-SS    | Shower Arm Flange (10 pcs per pack)  |
| 24 | 714-WT-02   | 6-inch Shower Arm  |
| 25 | 3034-1/2-02 | Shower Head 2.5 GPM  |
|    | T-3         | Handle Trim Set with Cold, Hot & Arrow indexed handles with screws and three escutcheons packed in a box         |

- If faucet has round handles (G-508) or (80 suffix) , use two Cold stem assemblies
- If faucet has lever handles, use one Hot and one Cold stem assemblies

**OPTIONS & REPLACEMENT PARTS**  
for options (see replacement part sheets for individual items)

| Suffix Number | Replaces Item # | Part Number        | Description   |
|---------------|-----------------|--------------------|---|
| 80            | A               | K-505-1C           | Silver Crown Acrylic Handles with indexed C metal button (G-503-M-02)                   |
|               |                 | K-505-1H           | Silver Crown Acrylic Handles with indexed H metal button (G-503-M-02)                   |
|               |                 | K-505-1D           | Silver Crown Acrylic Handles with indexed with Arrow metal button (503-MD) for diverter |
|               |                 | X126-625B          | Handle Screw for Acrylic Handles suffix 80 (6 pcs per pack)                             |
|               |                 | G-503-M-02         | Metal indexed buttons C & H for Acrylic Handles suffix 80 (one pair per pack)           |
|               |                 | 503-MD             | Metal button indexed with an arrow for diverter handle (1 pc)                           |
| C             | F               | G-30-C             | Direct Sweat Union Sleeve (X1875) & Nut (X1876-BB) For C suffix items only              |
|               | 12              | X1875-C            | Direct Sweat Union Sleeve (2 pcs per pack) for Item with C suffix                       |
|               |                 |                    |   |
|               | 10              | X263-BC            | Bronze Replacement Seat (10 pcs per pack)   |
|               | H               | 3007-8             | 8-inch Shower Arm (714-WT-02) & Flange (X1035-SS)                                       |
|               | F               | G-3113-8           | 8-inch Shower Arm (714-WT-02), Shower Head (3034-1/2-02), & Flange (X1035-SS)           |
|               |                 | <b>Accessories</b> |   |
|               |                 | G-1548-ET          | Stem Extension with Screw (X105-F)  |
|               |                 | X105-F             | Screw for stem extension (4 pcs per pack)   |
| Prefix Number | Replaces Item # | Part Number        | Description   |
| 8             | C               | K-351-C            | Ceramic-disc Stem Cartridge Cold with Gasket (X1028-Y)                                  |
| 8             | C               | K-351-H            | Ceramic-disc Stem Cartridge Hot with Gasket (X1028-Y)                                   |
|               |                 | For item           | <b>80968 only</b>   |

- If faucet has round handles (G-508) or (80 suffix) , use two K-351-C Cold stem assemblies
- If faucet has lever handles, use one Hot and one Cold stem assemblies

**For item 80968 only**

**K-351-C**

**K-351-H**

**Ceramic-disc Stem Cartridges  
with Gasket for Bath Valves**

**REPLACEMENT  
PARTS**

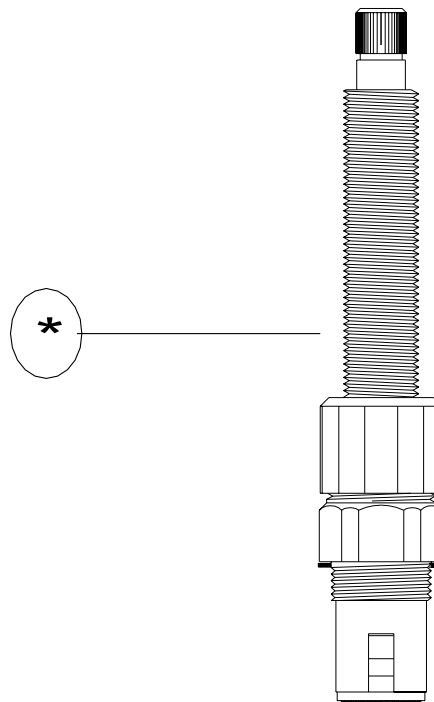

| # | Part Number | Description  |
|---|-------------|--|
|   | K-351-C     | Ceramic-disc Stem Cartridge Cold with Gasket (X1028-Y) |
|   | K-351-H     | Ceramic-disc Stem Cartridge Hot with Gasket (X1028-Y)  |
| 1 | X1028-Y     | Gasket (25 pcs per pack)                               |

- If faucet has round handles (G-508) or (80 suffix) , use two K-351-C Cold stem assemblies
- If faucet has lever handles, use one Hot and one Cold stem assemblies

## K-351-C & K-351-H Installation Instructions to replace Compression Stem Assemblies with Ceramic-Disc Cartridges

### DISASSEMBLY

1. Turn off water supply.
2. Remove handle and trim.
3. Remove old ceramic stem assembly using an adjustable wrench and turning counterclockwise.

### ASSEMBLY

1. Insert stem cartridge (with nylon gasket) into faucet. All components of the ceramic disc unit must be assembled as shown in the illustration.

2. Using an adjustable wrench, turn stem assembly clockwise with no more than 18 ft-lbs of torque, until secure.

**CAUTION: 18 ft-lbs is produced with a good pull on an 8-inch long wrench.**

**DO NOT OVERTIGHTEN.**

3. Turn unit to off position and turn on water supplies. Check for leakage around nylon gasket. If leaking, tighten stem slowly until leaking stops.

4. If the "on to off" rotation of the handle is incorrect, it may be reversed by removing the hex cap nut from the unit (see diagram) and sliding the stop washer off stem. Turn stop washer over, slide stop washer back onto unit and replace hex cap nut.

5. Replace handle and trim.

**NOTE:** If Cartridge becomes disassembled, replace components as shown in illustration. Ceramic discs must be positioned with the polished seal surfaces together.

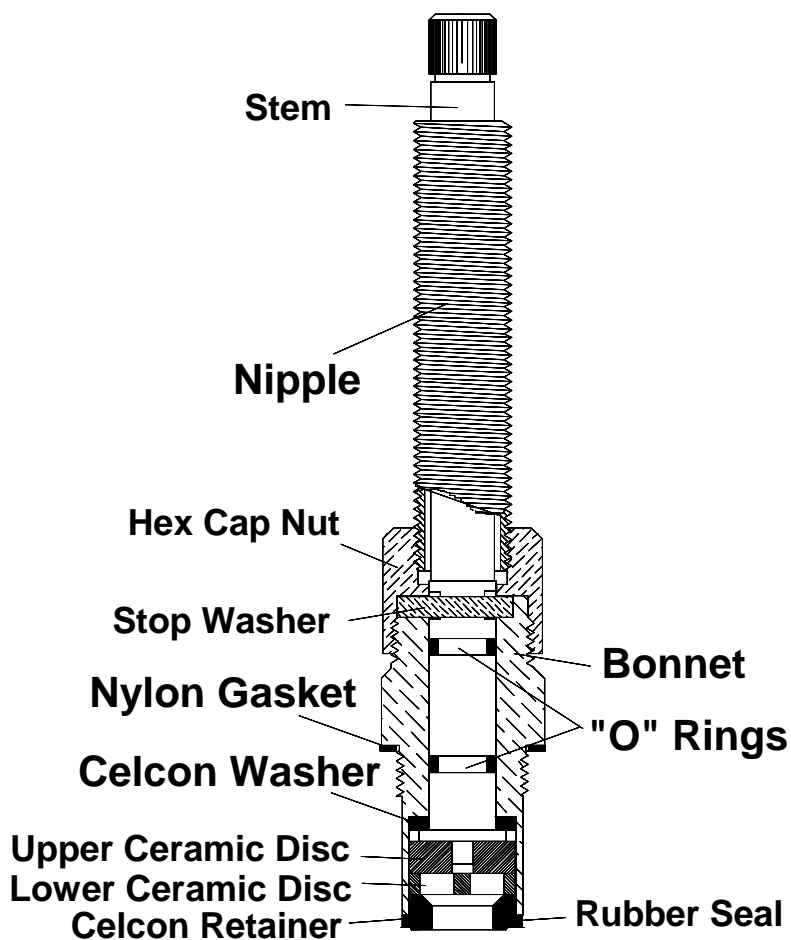

- If faucet has round handles (G-508) or (80 suffix) , use two K-351-C Cold stem assemblies
- If faucet has lever handles, use one Hot and one Cold stem assemblies