

Brecksville, Ohio 44141
 Phone:(216)883-0220 Fax: (440)526-5745
 www.CentralBrass.com

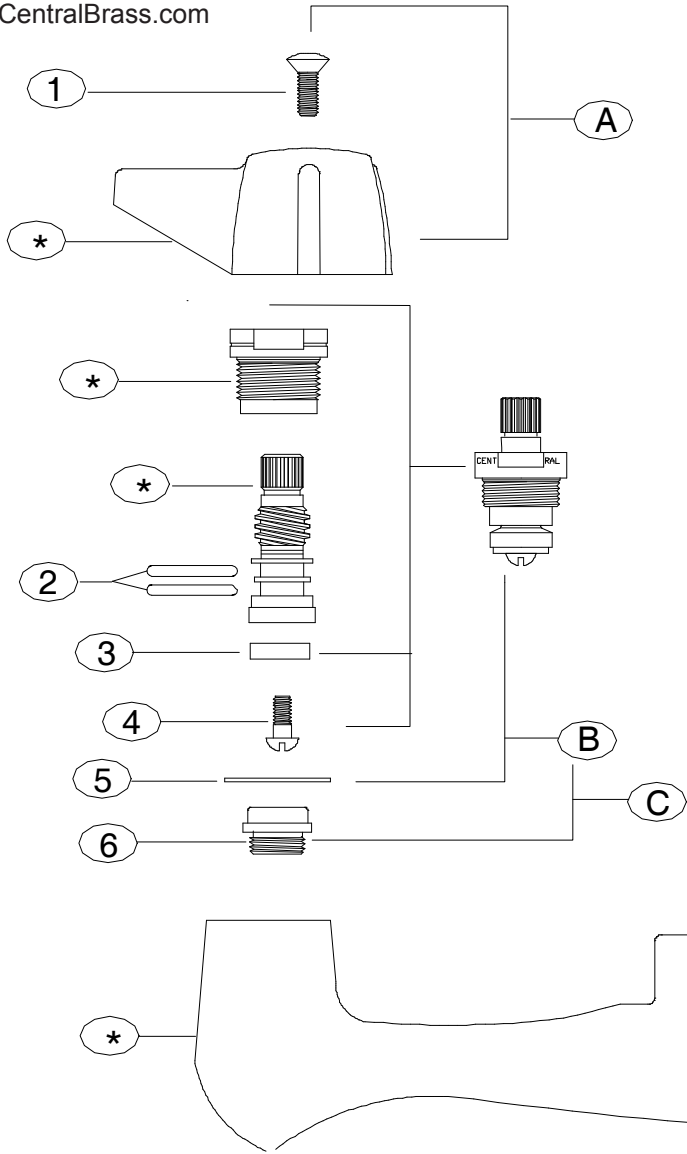

REPLACEMENT PARTS

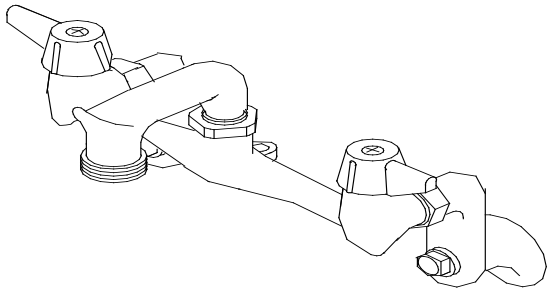
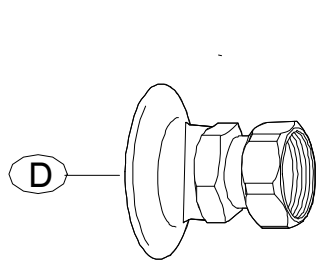
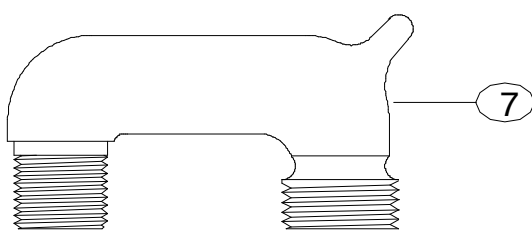

U - Suffix

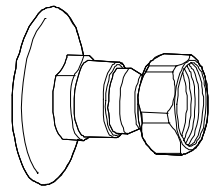

T-Suffix

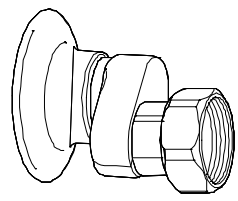

S - Suffix

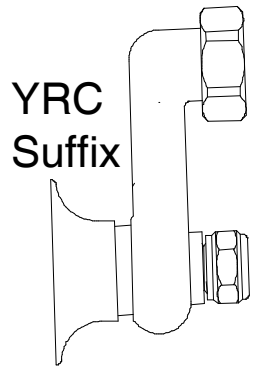

YRC Suffix

* These items are not offered individually and must be purchased as a group or unit. Please contact Central Brass for more information.

Brecksville, Ohio 44141
 Phone:(216)883-0220 Fax: (440)526-5745
 www.CentralBrass.com

REPLACEMENT PARTS

#	Part #	Description
A	G-523-C	Lever Handle C Indexed with Screw (X107-F)
A	G-523-H	Lever Handle H Indexed with Screw (X107-F)
B	G-453-EL	Cold O-Ring Stem Assembly with Gasket (X1028-Y)
B	G-453-ER	Hot O-Ring Stem Assembly with Gasket (X1028-Y)
C	K-453-C	Cold O-Ring Stem Assembly with Gasket (X1028-Y) and Seat (X263-BC)
C	K-453-H	Hot O-Ring Stem Assembly with Gasket (X1028-Y) and Seat (X263-BC)
D	SU-2807	Female Flange Adjustable 7 ⁷ / ₈ to 8 ¹ / ₈ inch Centers (U suffix)
D	SU-2846	Male Flange Adjustable 7 ⁷ / ₈ to 8 ¹ / ₈ inch Centers (T suffix)
D	SU-2806	Female Flange Adjustable 6 to 9 ¹ / ₂ inch Centers (S suffix)
D	SU-2841-ARC	Female Flange Adjustable 3 to 13 inch Centers with Integral Stops (YRC suffix)
1	X107-F	Handle Screw (25 pcs per pack)
2	X1038-453	O-Rings (25 pcs per pack)
3	X901-WNN	Stem Seat Washer (25 pcs per pack)
4	X104	Seat Washer Screw (25 pcs per pack)
5	X1028-Y	Gasket (25 pcs per pack)
6	X263-BC	Replacement Seat (10 pcs per pack)
7	1615-H	Rigid Spout with Pale Hook & Hose End

OPTIONS & REPLACEMENT PARTS for options (see replacement part sheets for individual items)

Suffix Number	Replaces Item #	Part Number	Description
EL	A	G-4149-C or H	6-Inch Brass Wrist Handles – Index Blue (X107-FB) or Index Red (X107-FR)
ELS	A	G-4147-C or H	4-Inch Brass Wrist Handles – Index Blue (X107-FB) or Index Red (X107-FR)
		X107-FB or FR	Blue Index or Red Index (5 pcs per pack) Used for EL, ELS and X suffix's

- If faucet has round handles (G-398), use two Hot stem assemblies
- If faucet has lever handles, use one Hot and one Cold stem assemblies

Brecksville, Ohio 44141
 Phone:(216)883-0220 Fax: (440)526-5745
 www.CentralBrass.com

SU-2806

Wall Mount Flange

Female Adjustable 6" to 9-1/2" Centers

S - SUFFIX

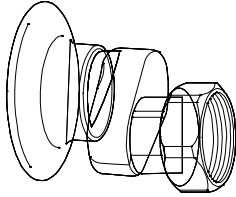

REPLACEMENT PARTS

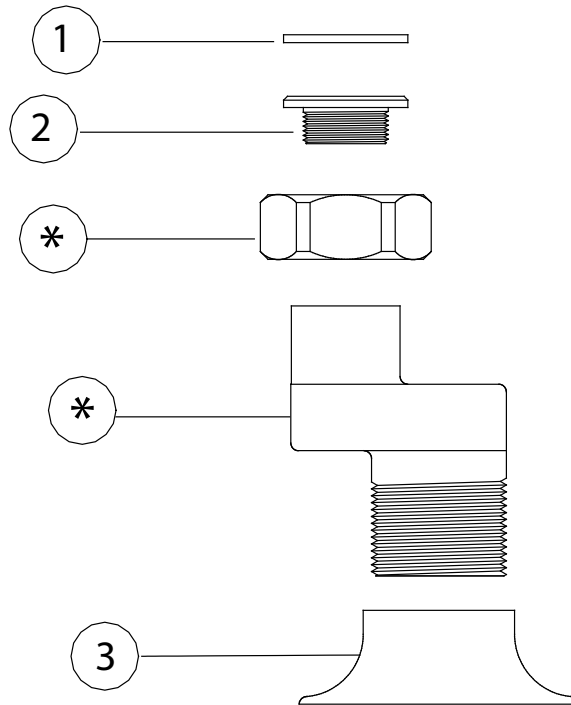

#	Part Number	Description
	SU-2806	Female Flange Adjustable 6 inch to 9-1/2 inch Centers
1	X940-TRN	Washer (10 pcs per pack)
2	PF-256-L	Shank Spud
3	390	Flange

* These items are not offered individually and must be purchased as a group or unit. Please contact Central Brass for more information.

Brecksville, Ohio 44141
 Phone:(216)883-0220 Fax: (440)526-5745
 www.CentralBrass.com

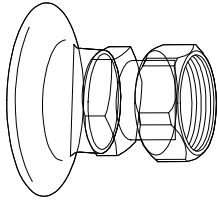

SU-2807

Wall Mount Flange

Female Adjustable 7-7/8" to 8-1/8" Centers

U - SUFFIX

REPLACEMENT PARTS

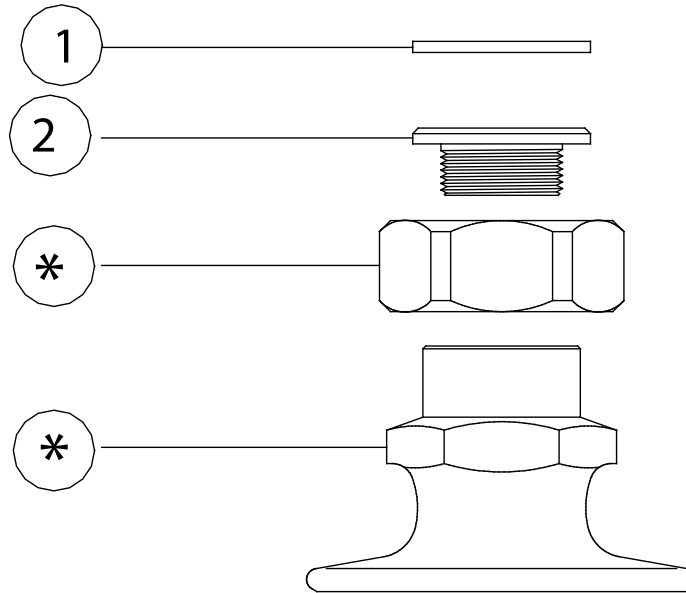

#	Part Number	Description
	SU-2807	Female Flange Adjustable 7-7/8 inch to 8-1/8 inch Centers
1	X940-TRN	Washer (10 pcs per pack)
2	PF-256-L	Shank Spud

* These items are not offered individually and must be purchased as a group or unit. Please contact Central Brass for more information.

Brecksville, Ohio 44141
 Phone:(216)883-0220 Fax: (440)526-5745
 www.CentralBrass.com

SU-2846

Wall Mount Flange

Male Adjustable 7-7/8" to 8-1/8" Centers

T - SUFFIX

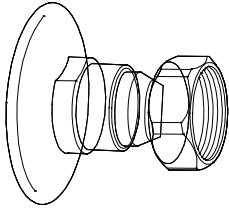

REPLACEMENT PARTS

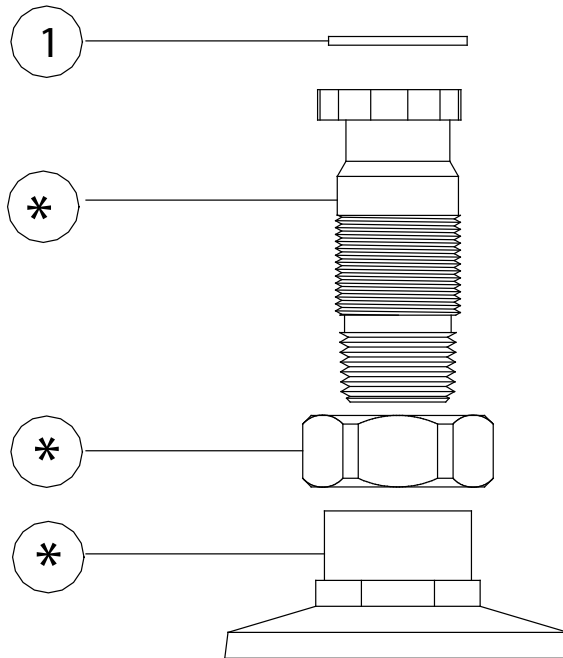

#	Part Number	Description
	SU-2846	Male Flange Adjustable 7-7/8 inch to 8-1/8 Centers
1	X940-TRN	Washer (10 pcs per pack)

* These items are not offered individually and must be purchased as a group or unit. Please contact Central Brass for more information.

Brecksville, Ohio 44141
 Phone:(216)883-0220 Fax: (440)526-5745
 www.CentralBrass.com

SU-2841-ARC

Wall Mount Flange

Female Adjustable 3" to 13" Centers
 with Integral Stops

YRC - Suffix

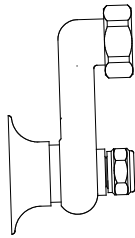

REPLACEMENT PARTS

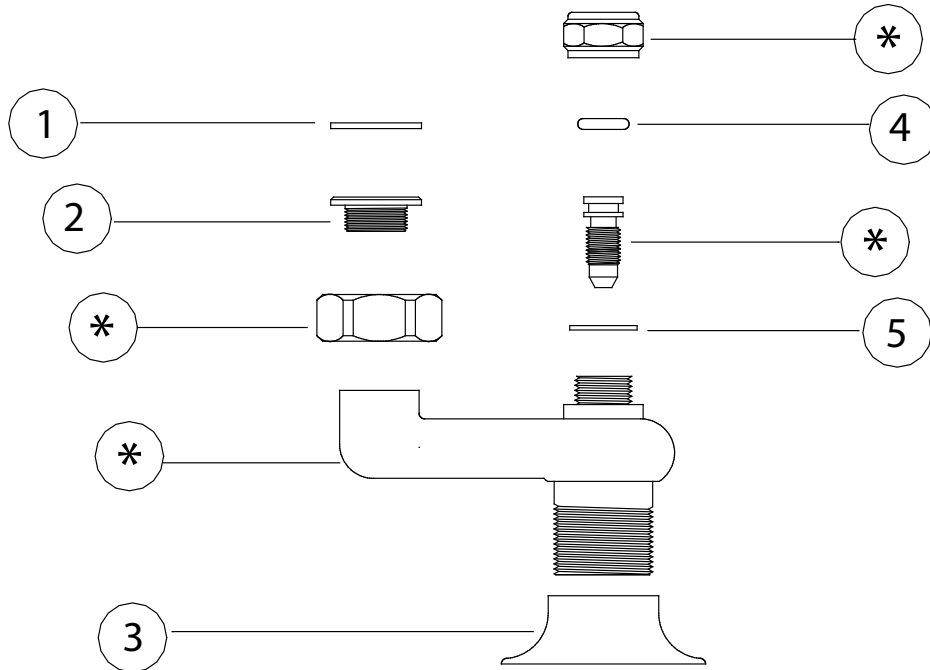

#	Part Number	Description
	SU-2841-ARC	Female Flange Adjustable 3 inches to 13 inches Centers with Integral Stops
1	X940-TRN	Washer (10 pcs per pack)
2	PF-256-L	Shank Spud
3	390	Flange
4	X1038-FN	O-Ring (10 pcs per pack)
5	X490-AP	Washer (12 pcs per pack)

* These items are not offered individually and must be purchased as a group or unit. Please contact Central Brass for more information.