

## Class 150 (Standard)

### FIG. 3107

Cross

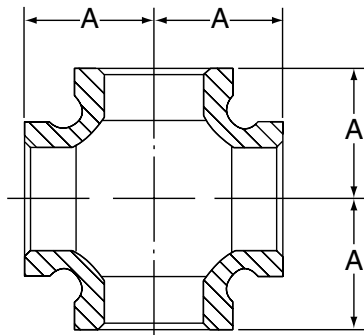

For Listings/Approval Details and Limitations, visit our website at [www.anvilintl.com](http://www.anvilintl.com) or contact an Anvil® Sales Representative.

**FIGURE 3107 - CROSS**

Nominal Size	Dimension A	Approx. Wt. Each
<i>In. (mm)</i>	<i>In. (mm)</i>	<i>Lbs. (kg)</i>
1/4	0.81	0.17
8	20.57	0.08
3/8	0.95	0.26
10	24.13	0.12
1/2	1.12	0.38
15	28.45	0.17
3/4	1.31	0.61
20	33.27	0.28
1	1.50	0.95
25	38.10	0.43
1 1/4	1.75	1.42
32	44.45	0.64
1 1/2	1.94	1.86
40	49.28	0.84
2	2.25	2.83
50	57.15	1.28

### MATERIAL SPECIFICATIONS

Dimensions: Fittings: ASME B16.3  
 Unions: ASME B16.39  
 Bushings/Plugs: ASME B16.14

Material: ASTM A-197

Finish: Black or Hot Dip Galvanized per ASTM A153 Class A

Threads\*: NPT per ASME B1.20.1

Pressure Ratings: Fittings: ASME B16.3  
 Unions: ASME B16.39  
 Bushings/Plugs: ASME B16.14

Pressure Testing: All malleable iron fittings are tested for through wall porosity using an air under water process.

Agency Approvals: All malleable iron fittings and unions are UL/ULC Listed and FM Approved.

\* British Standard threading per BS 21 available upon request.

#### PROJECT INFORMATION

#### APPROVAL STAMP

Project:	<input type="checkbox"/> Approved
Address:	<input type="checkbox"/> Approved as noted
Contractor:	<input type="checkbox"/> Not approved
Engineer:	Remarks:
Submittal Date:	
Notes 1:	
Notes 2:	