

Class 150 (Standard)

FIG. 3103

90° Street Elbow

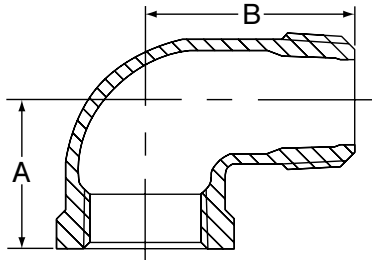

For Listings/Approval Details and Limitations, visit our website at www.anvilintl.com or contact an Anvil® Sales Representative.

FIGURE 3103 - 90° STREET ELBOW

Nominal Size	Dimensions		Approx. Wt. Each
	A	B	
<i>In. (mm)</i>	<i>In. (mm)</i>	<i>In. (mm)</i>	<i>Lbs. (kg)</i>
1/8	0.69	1.00	0.05
6	17.53	25.40	0.02
1/4	0.81	1.19	0.09
8	20.57	30.23	0.04
3/8	0.95	1.44	0.15
10	24.13	36.58	0.07
1/2	1.12	1.63	0.20
15	28.45	41.40	0.09
3/4	1.31	1.89	0.34
20	33.27	48.01	0.15
1	1.50	2.14	0.58
25	38.10	54.36	0.26
1 1/4	1.75	2.45	0.84
32	44.45	62.23	0.38
1 1/2	1.94	2.69	1.12
40	49.28	68.33	0.51
2	2.25	3.26	1.85
50	57.15	82.80	0.84
2 1/2	2.70	3.86	3.28
65	68.58	98.04	1.49
3	3.08	4.51	5.00
80	78.23	114.55	2.27
4	3.79	5.69	9.18
100	96.27	144.53	4.16

MATERIAL SPECIFICATIONS

Dimensions: Fittings: ASME B16.3
 Unions: ASME B16.39
 Bushings/Plugs: ASME B16.14
 Material: ASTM A-197
 Finish: Black or Hot Dip Galvanized per ASTM A153 Class A
 Threads*: NPT per ASME B1.20.1
 Pressure Ratings: Fittings: ASME B16.3
 Unions: ASME B16.39
 Bushings/Plugs: ASME B16.14

Pressure Testing: All malleable iron fittings are tested for through wall porosity using an air under water process.
 Agency Approvals: All malleable iron fittings and unions are UL/ULC Listed and FM Approved.

* British Standard threading per BS 21 available upon request.

PROJECT INFORMATION

APPROVAL STAMP

Project:	<input type="checkbox"/> Approved
Address:	<input type="checkbox"/> Approved as noted
Contractor:	<input type="checkbox"/> Not approved
Engineer:	Remarks:
Submittal Date:	
Notes 1:	
Notes 2:	